

LCD TV
(LED BACKLIGHT)



Owner's manual

ES Manual del propietario

FR Manuel du propriétaire

FW55D25F



To obtain a more detailed electronic copy of this manual or much further contents, go to

ES Para obtener una copia electronica detallada de este manual o mucho mayor contenido, visite

FR Pour obtenir une copie electronique plus detaillee de ce manuel ou pour aller encore plus loin, visitez

www.sanyo-av.com



Need help? Please call toll free **1 866 212 0436** or visit our web site above:

ES ¿Necesita ayuda? Llame por favor sin costo al **1 866 212 0436** ó visite nuestro sitio web en:

FR Besoin d'aide? Appelez notre numéro gratuit à **1 866 212 0436** ou visitez notre site web à l'adresse:

Contents

1	Notice	5
----------	---------------	----------

2	Getting started	7
	Features	7
	Supplied accessories	7
	Symbols used in this Owner's manual	7
	Stand assembly	8
	Attaching the base	8
	Managing cables	8
	Installing the remote control batteries	8
	Remote control	9
	Control panel	10
	Terminals	10
	Connecting antenna or Cable / Satellite set-top box	11
	Plugging in the AC power cord	11
	Selecting your connection quality	12
	Connecting your devices	12
	Initial setup	15

3	Use your TV	16
	Switching on your TV and putting it in standby mode	16
	Adjusting volume	16
	Switching channels	16
	Watching channels from an external device	17
	Changing picture and sound settings	17
	Sleep timer	17
	Switching audio mode	17
	Create a list of favorite channels	18
	Changing Pix Shape	18
	TV screen information	19

4	Making more use with your TV	20
	Displaying the main menu	20
	Picture	21
	Sound	22
	Setup	23
	Autoprogram	23
	Channel list	23
	Add channels	24
	Antenna confirmation	24
	Features	24
	Accessibility	24
	Child and ratings lock	26
	PC settings	29
	HDMI-CEC	29
	Setting your location to home	30
	E-sticker	30
	Language	31
	USB	31

5	Upgrade your TV software	33
	Checking your current software version	33
	Upgrading the software	33

6	Useful tips	34
	FAQ	34
	Troubleshooting tips	35

7	Information	36
	Glossary	36
	Maintenance	36

8	Specifications	37
----------	-----------------------	-----------

9	Warranty	38
----------	-----------------	-----------

**Register online today at sanyo-av.com/support/ today
to get the most benefits from your purchase.**

Registering your model with SANYO makes you eligible for all of the valuable benefits such as software upgrades and important product notifications.

Register Online at sanyo-av.com/support/

Know these **safety** symbols



The caution marking is located on the rear or bottom of the cabinet.



The lightning flash with arrowhead symbol, within an equilateral triangle, is intended to alert the user to the presence of uninsulated "dangerous voltage" within the apparatus's enclosure that may be of sufficient magnitude to constitute a risk of electric shock to persons.



The exclamation point within an equilateral triangle is intended to alert the user to the presence of important operating and maintenance (servicing) instructions in the literature accompanying the apparatus.

- WARNING:** To reduce the risk of fire or electric shock, do not expose this apparatus to rain or moisture. Apparatus shall not be exposed to dripping or splashing and no objects filled with liquids, such as vases, shall be placed on the apparatus.
- CAUTION:** To prevent electric shock, match wide blade of plug to wide slot, fully insert.
- ATTENTION:** Pour éviter les choc électriques, introduire la lame la plus large de la fiche dans la borne correspondante de la prise et pousser jusqu'au fond.

SANYO

Visit our World Wide Web Site at sanyo-av.com/support/

CHILD SAFETY:

PROPER TELEVISION PLACEMENT MATTERS

THE CONSUMER ELECTRONICS INDUSTRY CARES

- Manufacturers, retailers and the rest of the consumer electronics industry are committed to making home entertainment safe and enjoyable.
- As you enjoy your television, please note that all televisions – new and old- must be supported on proper stands or installed according to the manufacturer's recommendations. Televisions that are inappropriately situated on dressers, bookcases, shelves, desks, speakers, chests, carts, etc., may fall over, resulting in injury.

TUNE IN TO SAFETY

- **ALWAYS** follow the manufacturer's recommendations for the safe installation of your television.
- **ALWAYS** read and follow all instructions for proper use of your television.
- **NEVER** allow children to climb on or play on the television or the furniture on which the television is placed.
- **NEVER** place the television on furniture that can easily be used as steps, such as a chest of drawers.
- **ALWAYS** install the television where it cannot be pushed, pulled over or knocked down.
- **ALWAYS** route cords and cables connected to the television so that they cannot be tripped over, pulled or grabbed.

WALL OR CEILING MOUNT YOUR TELEVISION

- **ALWAYS** contact your retailer about professional installation if you have any doubts about your ability to safely mount your television.
- **ALWAYS** use a mount that has been recommended by the television manufacturer and has a safety certification by an independent laboratory (such as UL, CSA, ETL).
- **ALWAYS** follow all instructions supplied by the television and mount manufacturers.
- **ALWAYS** make sure that the wall or ceiling where you are mounting the television is appropriate. Some mounts are not designed to be mounted to walls and ceilings with steel studs or cinder block construction. If you are unsure, contact a professional installer.
- Televisions can be heavy. A minimum of two people is required for a wall or ceiling mount installation.

MOVING AN OLDER TELEVISION TO A NEW PLACE IN YOUR HOME

- Many new television buyers move their older CRT televisions into a secondary room after the purchase of a flat-panel television. Special care should be made in the placement of older CRT televisions.
- **ALWAYS** place your older CRT television on furniture that is sturdy and appropriate for its size and weight.
- **NEVER** place your older CRT television on a dresser where children may be tempted to use the drawers to climb.
- **ALWAYS** make sure your older CRT television does not hang over the edge of your furniture.

CTA.tech/safety **Consumer Technology Association™**

Important safety instructions

1. Read these instructions.
2. Keep these instructions.
3. Heed all warnings.
4. Follow all instructions.
5. Do not use this apparatus near water.
6. Clean only with dry cloth.
7. Do not block any ventilation openings. Install in accordance with the manufacturer's instructions.
8. Do not install near any heat sources such as radiators, heat registers, stoves, or other apparatus (including amplifiers) that produce heat.
9. Do not defeat the safety purpose of the polarized or grounding-type plug. A polarized plug has two blades with one wider than the other. A grounding type plug has two blades and a third grounding prong. The wide blade or the third prong are provided for your safety. If the provided plug does not fit into your outlet, consult an electrician for replacement of the obsolete outlet.
10. Protect the power cord from being walked on or pinched particularly at plugs, convenience receptacles, and the point where they exit from the apparatus.
11. Only use attachments / accessories specified by the manufacturer.
12. Use only with the cart, stand, tripod, bracket, or table specified by the manufacturer, or sold with the apparatus. When a cart is used, use caution when moving the cart / apparatus combination to avoid injury from tip-over.



13. Unplug this apparatus during lightning storms or when unused for long periods of time.
14. Refer all servicing to qualified service personnel. Servicing is required when the apparatus has been damaged in any way, such as power-supply cord or plug is damaged, liquid has been spilled or objects have fallen into the apparatus, the apparatus has been exposed to rain or moisture, does not operate normally, or has been dropped.

Note to the CATV system installer:

This reminder is provided to call the CATV system installer's attention to Article 820-40 of the NEC that provides guidelines for proper grounding and, in particular, specifies that the cable ground shall be connected to the grounding system of the building, as close to the point of cable entry as practical.

Example of antenna grounding as per NEC - National Electric Code

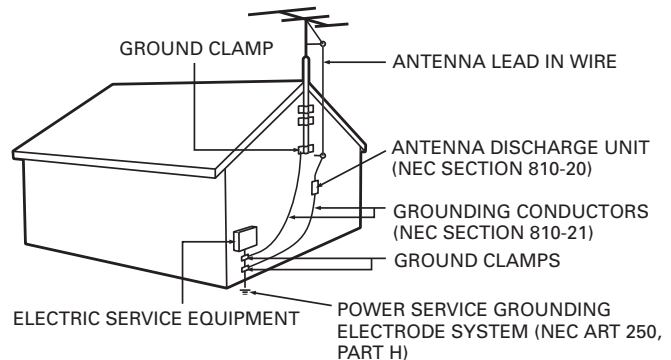

Wall mount bracket kit

	Brand	Model #	Screw dimension
FW55D25F	SANUS	PLA50B	M6 x 0.472" (12mm)

- Your TV meets the VESA standard for wall mounting. Consult with your local dealer for a wall mount bracket which is compatible with your TV model.
- The recommended wall mount bracket kit (sold separately) allows the mounting of the TV on the wall.
- For detailed information on installing the wall mount, refer to the wall mount Instruction book.
- Funai Corporation is not responsible for any damage to the product or injury to yourself or others if you elect to install the TV wall mount bracket or mount the TV onto the bracket on your own.
- The wall mount bracket must be installed by experts.

Funai Corporation is not liable for these types of accidents or injuries noted below.

- Install the wall mount bracket on a sturdy vertical wall.
- If installed onto a ceiling or slanted wall, the TV and wall mount bracket may fall which could result in a severe injury.
- Do not use screws that are longer or shorter than their specified length. If screws too long are used this may cause mechanical or electrical damage inside the TV set. If screws too short are used this may cause the TV set to fall.
- Do not fasten the screws by excessive force. This may damage the product or cause the product to fall, leading to an injury.
- For safety reasons use 2 people to mount the TV onto a wall mounting bracket.
- Do not mount the TV onto the wall mounting bracket while your TV is plugged in or turned on. It may result in an electrical shock injury.

When installing the unit on the wall, allow this much space.

Top	: 11.8 inches (30cm)
Left and right side	: 5.9 inches (15cm)
Bottom	: 3.9 inches (10cm)

1 Notice

SANYO is a registered trademark of SANYO Electric Co., Ltd. and is used by Funai Electric Co., Ltd. and Funai Corporation, Inc. under license from SANYO Electric Co., Ltd.

Any liability related to SANYO products, including design and quality, is the sole responsibility of Funai Electric Co., Ltd. and Funai Corporation, Inc.

Please contact Funai Corporation, Inc. for any questions or claims related to SANYO products: www.sanyo-av.com

Funai Corporation reserves the right to change products at any time without being obliged to adjust earlier supplies accordingly.

The material in this Owner's manual is believed adequate for the intended use of the system. If the product or its individual modules or procedures are used for purposes other than those specified herein, confirmation of their validity and suitability must be obtained. Funai Corporation warrants that the material itself does not infringe any United States patents. No further warranty is expressed or implied.

Funai Corporation cannot be held responsible neither for any errors in the content of this document nor for any problems as a result of the content in this document. Errors reported to Funai Corporation will be adapted and published on the Funai Corporation support website as soon as possible.

Pixel characteristics

This LCD product has a high number of color pixels. Although it has effective pixels of 99.999% or more, black dots or bright points of light (red, green or blue) may appear constantly on the screen. This is a structural property of the display (within common industry standards) and is not a malfunction.

Warranty

No components are user serviceable. Do not open or remove covers to the inside of the product. Repairs may only be done by service centers and official repair shops. Failure to do so shall void any warranty, stated or implied.

Any operation expressly prohibited in this Owner's manual, any adjustments or assembly procedures not recommended or authorized in this Owner's manual shall void the warranty.

Federal communications commission notice

This equipment has been tested and found to comply with the limits for a Class B digital device, pursuant to part 15 of the FCC Rules.

These limits are designed to provide reasonable protection against harmful interference in a residential installation. This equipment generates, uses and can radiate radio frequency energy and, if not installed and used in accordance with the instructions, may cause harmful interference to radio communications. However, there is no guarantee that interference will not occur in a particular installation. If this equipment does cause harmful interference to radio or television reception, which can be determined by turning the equipment off and on, the user is encouraged to try to correct the interference by one or more of the following measures:

- Reorient or relocate the receiving antenna.
- Increase the separation between the equipment and the receiver.
- Connect the equipment into an outlet on a circuit different from that to which the receiver is connected.
- Consult the dealer or an experienced radio or television technician for help.

This device complies with Part 15 of the FCC rules. Operation is subject to the following two conditions: (1) This device may not cause harmful interference, and (2) This device must accept any interference received, including interference that may cause undesired operation.

Declaration of conformity

Trade name : SANYO
 Responsible party : Funai Corporation, Inc.
 Model : FW55D25F
 Address : 12489 Lakeland Road, Santa Fe Springs, CA 90670, USA*
 Telephone number : 1 866 212 0436

* This is not the mailing address for Open Source Software or Customer service.

Modifications

This apparatus may generate or use radio frequency energy. Changes or modifications to this apparatus may cause harmful interference.

Any modifications to the apparatus must be approved by Funai Corporation.

The user could lose the authority to operate this apparatus if an unauthorized change or modification is made.

Cables

Connections to this device must be made with shielded cables with metallic RFI / EMI connector hoods to maintain compliance with FCC Rules and regulations.

Canadian notice

CAN ICES-3 (B)/NMB-3 (B)

Analog and digital television receiving apparatus, Canada BETS-7 / NTMR-7.

Positioning the TV

- Large screen TVs are heavy. 2 people are required to carry and handle a large screen TV.
- Make sure to hold the upper and bottom frames of the unit firmly as illustrated.
- Install the unit in a horizontal and stable position.
- Do not install the unit in direct sunlight or in a place subject to dust or strong vibration.
- Depending on the environment, the temperature of this unit may increase slightly. This is not a malfunction.
- Avoid a place with drastic temperature changes.
- Do not place anything directly on top or bottom of the Unit.
- Depending on your external devices, noise or disturbance of the picture and / or sound may be generated if the unit is placed too close to them. In this case, please ensure enough space between the external devices and the unit.
- Do not insert the AC power cord into the power socket outlet before all the connections are made.
- Ensure that you always have easy access to the AC power cord and outlet to disconnect the TV from the AC outlet.
- Before you move the TV, disconnect attached cables to prevent damage to connectors, especially the TV tuner.
- Be sure to unplug the AC power plug from the AC outlet before moving or carrying the unit.
- When moving the TV and then setting it down, please be careful not to pinch the AC power cord under the unit.
- Do not place this unit in an area where it may be exposed to water, oil or grease such as: near a bathtub, basin, kitchen sink, washing tub, swimming pool, kitchen exhaust fan, etc., or in a damp basement.

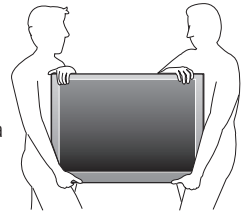

Regulatory notices

Do not place the unit on the furniture that is capable of being tilted by a child and an adult leaning, pulling, standing or climbing on it. A falling unit can cause serious injury or even death.

This apparatus should not be placed in a built-in installation such as a bookcase or rack unless proper ventilation is provided. Make sure to leave a space of 4 inches (10 cm) or more around this apparatus.

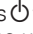
Press  to turn the unit on and go into standby mode. To completely turn off the unit, you must unplug the AC power plug from the AC power outlet.

Disconnect the AC power plug to shut the unit off when trouble is found or not in use. The AC plug shall remain readily available.

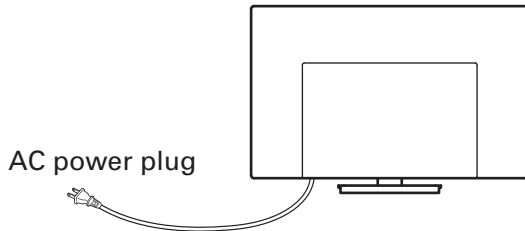

Never use a gas duster on this TV.

The gas trapped inside of this unit may cause ignition and explosion.

CAUTION : Danger of explosion if battery is incorrectly replaced. Replace only with the same or equivalent type.

WARNING : Batteries (battery pack or battery installed) should not be exposed to excessive heat such as sunshine, fire or the like.

WARNING : To prevent injury, this apparatus must be securely attached to the furniture / wall in accordance with the instructions. Tipping, shaking or rocking the unit may cause injury / death.

Environmental care



The packaging of this product is intended to be recycled.

Contact your local authorities for information about how to recycle the packaging.

For product recycling information, please visit - www.sanyo-av.com

Click on



End of life directives

SANYO pays a lot of attention to produce environmental-friendly products in green focal areas. Your new TV contains materials which can be recycled and reused. At the end of its life, specialized companies can dismantle the discarded TV to concentrate the reusable materials and to minimize the amount of materials to be disposed of. Please ensure you dispose of your old TV according to local regulations.

Batteries usage

- Do not mix old and new batteries.
- Do not mix alkaline, standard (carbon-zinc) or rechargeable (ni-cad, ni-mh, Li-ion, etc.) batteries.

Disposal of used batteries

In certain localities, disposing batteries with household waste is not permitted. Please ensure you dispose of batteries according to local regulations.

Preparing to move / ship the unit

Please pack the unit properly by following the diagram on the carton (as noted below).

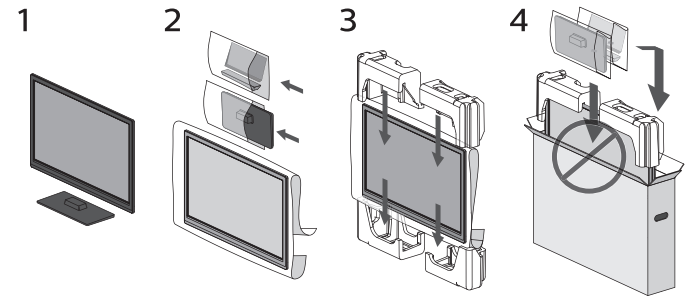

- To avoid damage to the screen, do not pack the stand on the same side as the TV screen, refer to the step 4 above.

Copyright

All other registered and unregistered trademarks are the property of their respective owners.



The terms HDMI and HDMI High-Definition Multimedia Interface, and the HDMI Logo are trademarks or registered trademarks of HDMI Licensing Administrator, Inc. in the United States and other countries.



Manufactured under license from Dolby Laboratories. Dolby and the double-D symbol are trademarks of Dolby Laboratories Licensing Corporation.



ENERGY STAR® is a joint program of the U.S. Environmental Protection Agency and the U.S. Department of Energy helping us all save money and protect the environment through energy efficient products and practices.

Consumer notice:

This TV has been set to maximize energy efficiency while delivering the best possible picture using the factory installed home mode settings. Changing or enabling other features in this TV (e.g. brightened backlighting) will possibly increase energy consumption beyond the original ENERGY STAR® qualified limits.

Portions of this software are copyright © The FreeType Project (www.freetype.org).

The American Academy of Pediatrics discourages television viewing for children younger than two years of age.

© 2016 Funai Electric Co., Ltd. All rights reserved.

No part of this Owner's manual may be reproduced, transmitted, disseminated or transcribed, in any form or for any purpose without the express prior written consent of Funai Corporation. Furthermore, any unauthorized commercial distribution of this Owner's manual or any revision hereto is strictly prohibited.

2 Getting started

Features

- **DTV / Analog TV / CATV**
You can use your remote control to select channels which are broadcast in digital format and conventional analog format. Also, cable and satellite subscribers can access their TV channels.
- **Information display**
You can display on the TV screen the title, contents (DTV only) and other information on the current program.
- **Autoprogram**
This unit automatically scans and memorizes channels available in your area, eliminating difficult setup procedures.
- **Child lock**
This feature allows you to block children's access to inappropriate programs.
- **Closed caption decoder**
Built-in closed caption decoder displays text for closed caption supported programs.
- **MTS / SAP tuner**
Audio can be selected from the remote control.
- **Auto standby**
If there is no input signal and no operation for 15 minutes, the unit will go into standby mode automatically.
- **Sleep timer**
You can set the unit to go into standby mode after a specific amount of time.
- **Choices for On-screen language**
Select your On-screen language: English, Spanish or French.
- **Stereo sound function**
- **PLL frequency synthesized tuning**
Provides free and easy channel selection and lets you tune directly to any channel using the number and decimal point "*" keys on the remote control.
- **Various adjustments for picture and sound**
Customizes picture quality suitable for your room and sets your sound preference.
- **HDMI-CEC via HDMI link**
HDMI-CEC allows your other HDMI link Devices to be controlled by the HDMI cable connected to your TV.
- **HDMI input**
- **HDMI-DVI input**
If your video device has a DVI output jack, use an HDMI-DVI conversion cable to connect the unit.
- **Component video input**
- **PC input**
Input from a computer.
- **AV input**
Audio and video input from an external device.
- **USB terminal**
The picture (JPEG) and video (Motion JPEG) files stored on a USB memory stick can be played back on this unit.
- **Digital audio output**
Digital audio (Supporting Dolby Digital) sent to home theaters and other digital audio systems.
- **Headphone audio output**
Headphone 3.5mm stereo jack for personal listening.

Supplied accessories

Owner's Manual

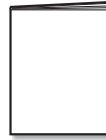

Quick Start Guide



Remote Control*



TV base and Screws



Screws packed with this Unit.

Model	Quantity	Size
FW55D25F	8	M4 x 0.472" (12mm)
	2	M5 x 0.472" (12mm)

* Batteries not included, AAA 1.5V x 2 Required.

Cable management tie

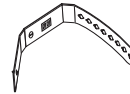

Note(s)

- If you lose the screws, please purchase the above-mentioned Phillips head screws at your local store.
- If you need to replace these accessories, please refer to the part name or No. with the illustrations and call our toll free customer support line found on the cover of this Owner's manual.

When using a universal remote control to operate this unit.

- Make sure the component code on your universal remote control is set to our brand. Refer to the instruction book accompanying your remote control for more details.
- We do not guarantee 100% interoperability with all universal remote controls.

Symbols used in this Owner's manual

The following is the description for the symbols used in this Owner's manual. Description refers to:

Digital TV operation

Cable / NTSC (Analog) TV operation

- If neither symbol appears, the operation is applicable to both.

Stand assembly

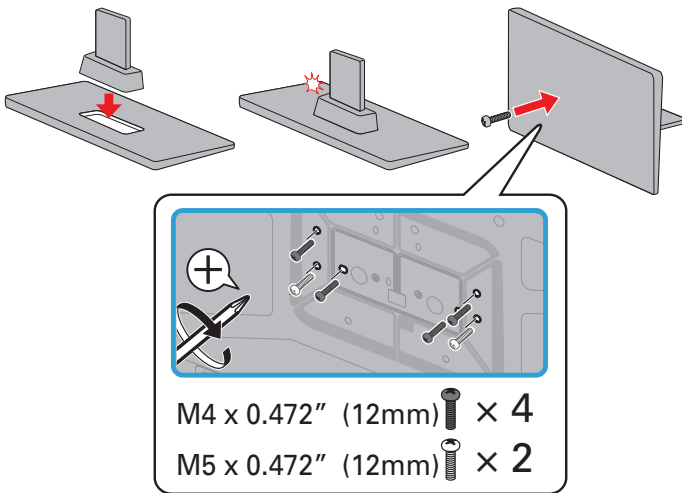

Attaching the base

You must attach the base to the unit to have it as a table top unit. Be sure the front and rear of the base match the proper direction. For large screen TVs, at least 2 people are required for these steps.

1

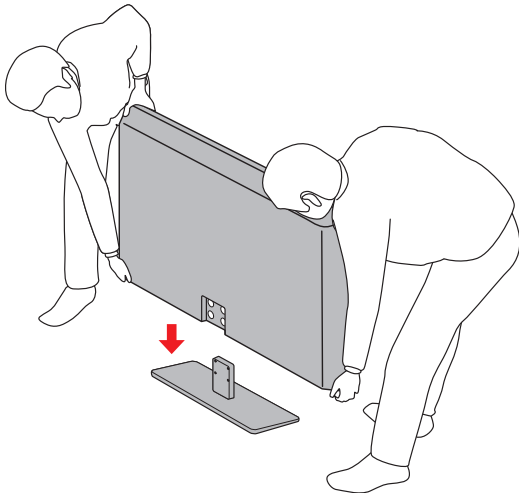

2

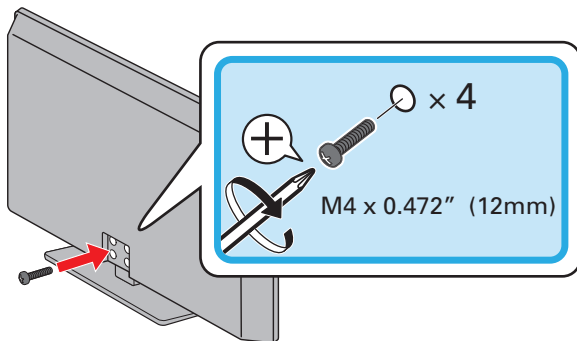

Managing cables

Route your antenna cable and all other cables through the cable management tie at the back of the TV. The holder helps keep your cables tidy and easily manageable.

1 Attach the cable management tie as illustrated below.

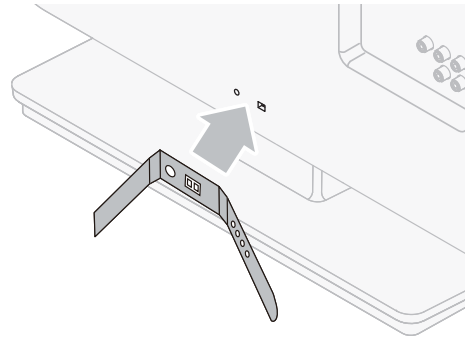

2 Pass cables through the cable management tie to avoid tangles.

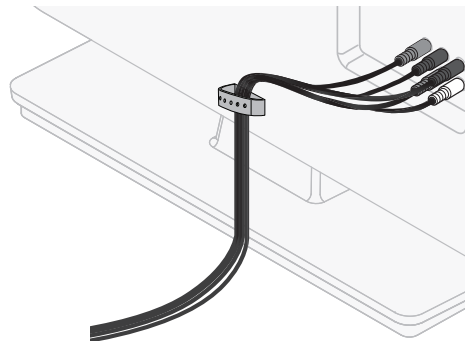

Installing the remote control batteries

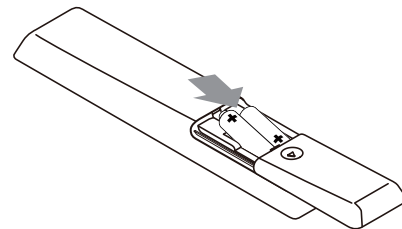

1 Slide the battery cover off the back of the remote control.

2 Insert two batteries (AAA, 1.5V). Be sure the + and – ends of the batteries line up with the markings inside the case.

3 Slide the cover back into position.

Note(s)

- Remove the batteries if not using the remote control for an extended period of time.

Note(s)

- Make sure to use a table which can support the weight of this unit and is larger than this unit.
- Make sure the table is in a stable location.
- When attaching the base, ensure that all screws are tightly fastened. If the base is not properly attached, it could cause the unit to fall, resulting in injuries as well as damage to the unit.
- To remove the base from this unit, unscrew the Phillips head screws by the reversing procedure. Be careful not to drop the base when you remove it.

Continued on next page.

Remote control



- ① **⏻ (POWER / STANDBY)**
Turns the TV on from standby or off to standby mode.
- ② **PIC/SOUND MODE**
Optimizes picture and sound quality.
- ③ **CC**
Selects closed caption settings (Off, On, CC w/ mute).
- ④ **0 - 9 (NUMBER keys)**
Used to enter a channel / program number.
• **(DOT)** : Use with 0-9 to select digital channels. For example, to enter 2.1, press
- PREV.CH** : Returns to the previously viewed channel.
- CH + / -** : Selects a channel in the memorized channel ring (low to high or high to low).
- ⑤ **SAP**
Selects audio mode (MONO / STEREO / SAP) / audio language.
- ⑥ **VOL + / -**
Adjusts the volume.
- ⑦ **🔇 (MUTE)**
Turns the sound on and off.
- ⑧ **BACK**
Returns to the previous menu operation.
- ⑨ **▲▼◀▶ (NAVIGATION keys) / OK**
Moves the cursor, selects the On-screen menu items.
- ⑩ **SOURCE**
Selects connected devices.
- ⑪ **SLEEP**
Sets sleep timer.
- ⑫ **PIX SHAPE**
Adjusts the picture size on the TV screen.
- ⑬ **INFO**
Displays information about the current program.
- ⑭ **MENU**
Opens the main On-screen menu.

Control panel

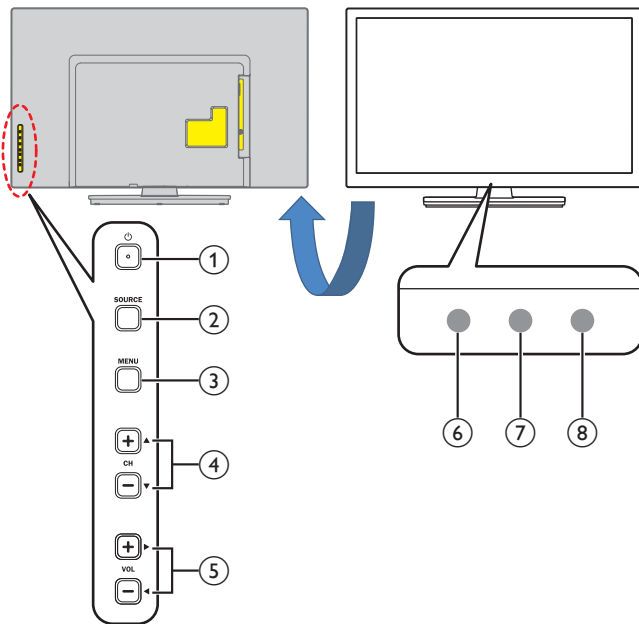

- ① **⏻ (POWER / STANDBY)**
Turns the TV on from standby or off to standby mode.
- ② **SOURCE**
Selects connected devices.
- ③ **MENU**
Opens the main On-screen menu.
- ④ **CH ▲ / ▼**
Selects a channel in the memorized channel ring (low to high or high to low). In the menu screen, moves the cursor up (▲) (+) / down (▼) (-).
- ⑤ **VOL ◀ / ▶**
Adjusts the volume.
VOL ◀ (-) : Volume down
VOL ▶ (+) : Volume up
In the menu screen, moves the cursor left (◀) (-) / right (▶) (+).
- ⑥ **Remote control sensor**
Receives IR signal from remote control.
Do not block this remote control sensor window to allow proper operation.
- ⑦ **Ambient light sensor**
Alters the brightness of the TV screen automatically by detecting your room lighting level. Do not block this light sensor window to allow proper operation.
- ⑧ **Power on / Standby indicator**
(On : no light, Standby : red light)

Terminals

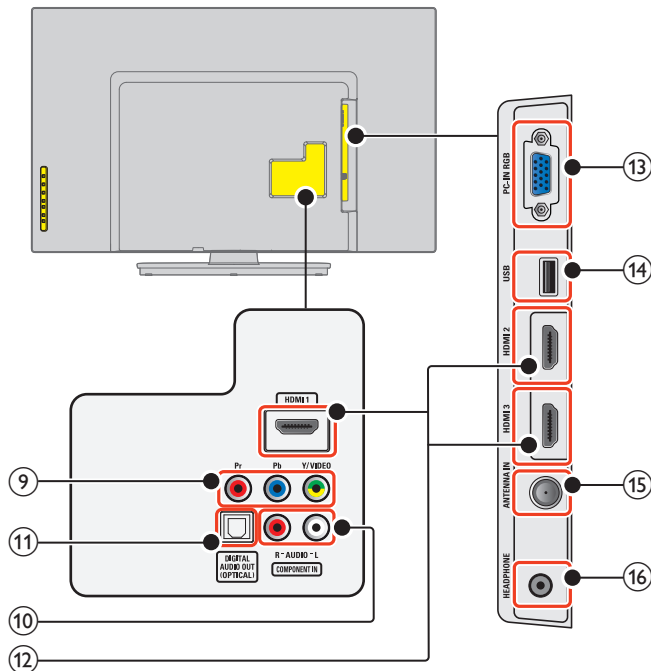

- ⑨ **Component (Y/Pb/Pr) / Composite video (VIDEO) input jack(s) for VIDEO**
Composite video input (VIDEO) jack is a shared jack with component video input (Y) jack. Green / Yellow color orientation depends on model.
- ⑩ **Analog audio (L/R) input jacks**
Connect analog audio signals from;
 - HDMI-DVI / Analog audio (L/R) jacks signal
 - Component video / Analog audio (L/R) jacks signal
 - Composite video / Analog audio (L/R) jacks signal
 - PC connection / Analog audio (L/R) jacks signal from stereo mini 3.5mm plug audio cable on PC.
- ⑪ **Digital audio output jack**
Digital audio (S/PDIF) output to home theaters and other digital audio systems.
- ⑫ **HDMI input jack(s)**
Digital audio and video input from high-definition digital devices such as DVD / Blu-ray disc players, cable or set-top boxes and PC's.
- ⑬ **PC input jack**
VGA cable connection for PC.
- ⑭ **USB terminal**
Data input from USB memory stick only.
Do not connect any device to this terminal such as; digital camera, keyboard, mouse, etc.
- ⑮ **75 ohm cable / Antenna connection**
Signal input from an antenna, cable or set-top boxes.
- ⑯ **Headphone audio output jack**
Headphone 3.5mm stereo jack for personal listening.

Connecting antenna or Cable / Satellite set-top box

Be sure your antenna or another device is connected properly before plugging in the AC power cord.

If connecting to an antenna through an RF cable

Any DTV programs that are broadcast in your area can be received for free through an antenna connection.

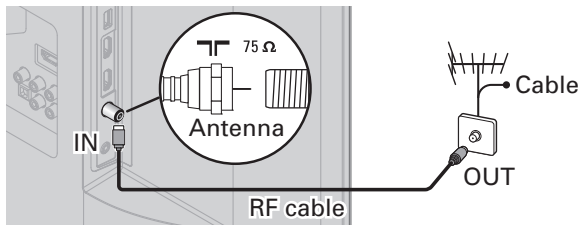

If connecting cable / satellite set-top box using an RF cable

If the TV is connected to a cable or set-top box via a coaxial connection, set the TV to channel 3/4 or the channel specified by the service provider.

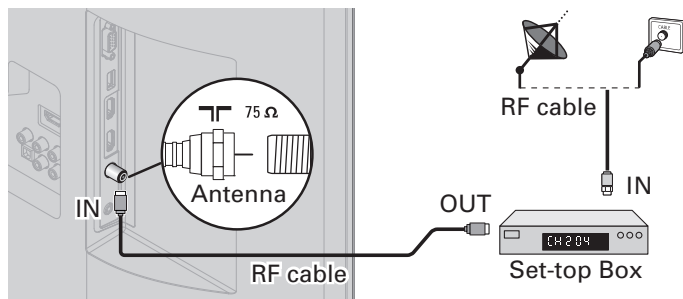

If connecting cable / satellite set-top box using an HDMI cable

If the TV is connected to a cable / satellite set-top box via an HDMI cable, make sure you select the correct source by using **SOURCE**.

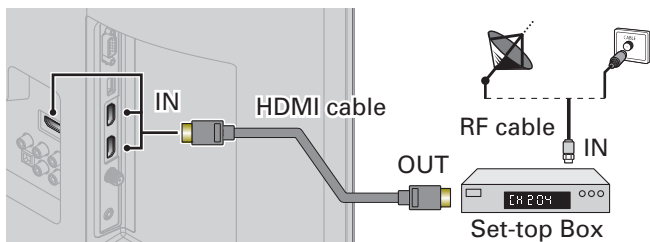

If connecting cable / satellite set-top box using component video input

If the TV is connected to a cable / satellite set-top box via component video input, make sure you select the correct component video source by using **SOURCE**.

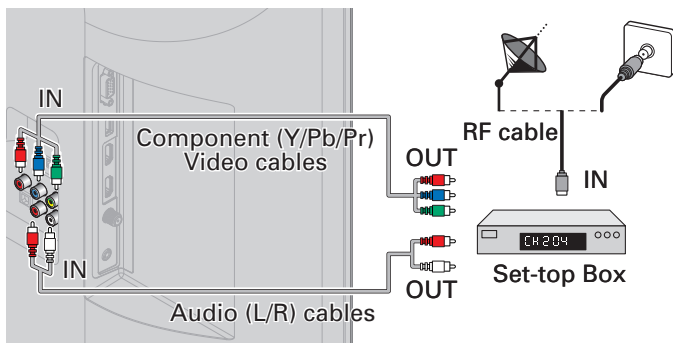

Connecting a Cable / Satellite set-top box, Blu-ray disc / DVD recorder via composite connectors and analog audio

Do not place your recorder too close to the screen because some recorders can be susceptible to signals from the TV.

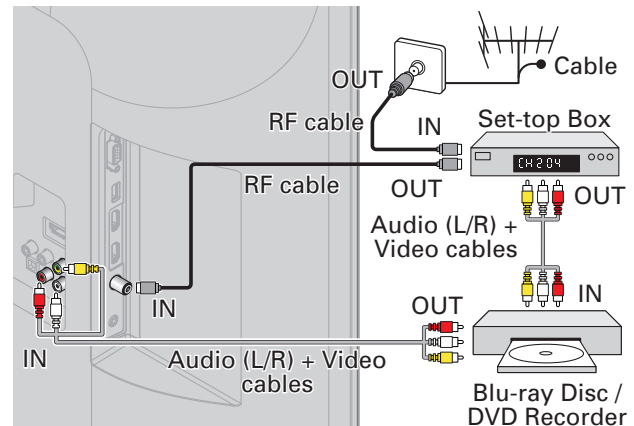

Note(s)

- If you have any question about the DTV's antenna, visit www.antennaweb.org for further information.
- Depending on your antenna system, you may need different types of combiners (mixers) or separators (splitters) for HDTV signal. The minimum RF bandpass on these devices is 2,000MHz or 2GHz.
- For your safety and to avoid damage to this unit, please unplug the RF coaxial cable from the antenna input jack before moving the unit.
- If you did use an antenna to receive analog TV, it should also work for DTV reception. Outdoor or attic antennas will be more effective than a set-top box or inside antenna.
- To turn on your reception source easily between antenna and cable, install an antenna selector.
- If you are not receiving a signal from your cable service, contact the cable provider.
- Refer to the Quick start guide that shows the connections for the HDMI or component input mode.

Plugging in the AC power cord

Make sure all the necessary connections are made before the AC power cord is plugged into an AC outlet.

! Caution(s)

- Connect the analog audio signal cables from the external device to the analog audio L/R input jacks.
- If you have an amplifier, connect the HDMI cable to the HDMI input via your amplifier.

Note(s)

- Each time you plug in the AC power cord, no operations will be performed for several seconds. This is not a malfunction.

No supplied cables are used with these connections:

- Please purchase the necessary cables at your local store.

Before you connect the AC power cord:

Be sure other devices are connected properly before plugging in the AC power cord.

Selecting your connection quality

HDMI - Highest quality

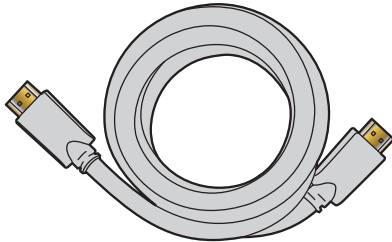

Supports High-Definition Digital signals and gives highest picture and sound quality. Video and Audio signals are combined in one cable. You must use HDMI for full High-Definition Video and to enable HDMI-CEC.

Note(s)

- SANYO HDMI supports HDCP (High-bandwidth Digital Contents Protection). HDCP is a form of digital rights management that protects high-definition content in Blu-ray discs or DVDs.

Component (Y Pb Pr) - High quality

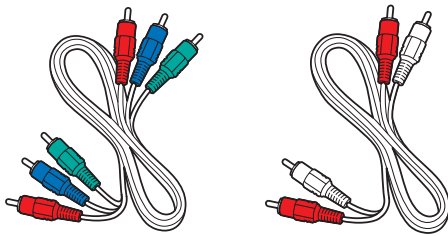

Supports high-definition analog signals but gives lower picture quality than HDMI. Component (Y/Pb/Pr) video cables combine red / green / blue video cables with red / white audio (L/R) cables. Match the cable colors when you connect to the TV.

Composite - Basic quality

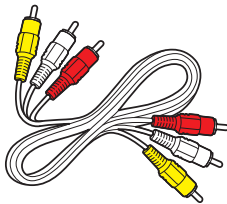

For analog connections. Composite video / Audio analog cable usually combine a yellow video cable with red / white audio (L/R) cables. With this unit, yellow cable must be connected to Y (green) jack on the component video input jacks.

Connecting your devices

HDMI digital connection

HDMI connection offers the highest picture quality. HDMI (High-Definition Multimedia Interface) transports high-definition digital video and multi-channel digital audio through a single cable.

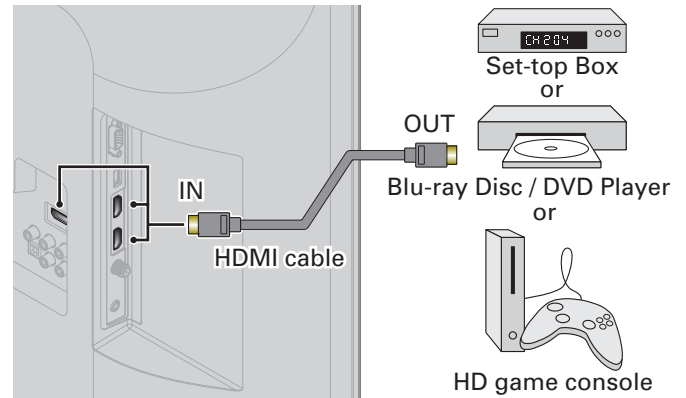

HDMI-DVI connection

This unit can be connected to your device that has a DVI terminal. Use an HDMI-DVI conversion cable for this connection and it requires audio cable for analog audio signal as well.

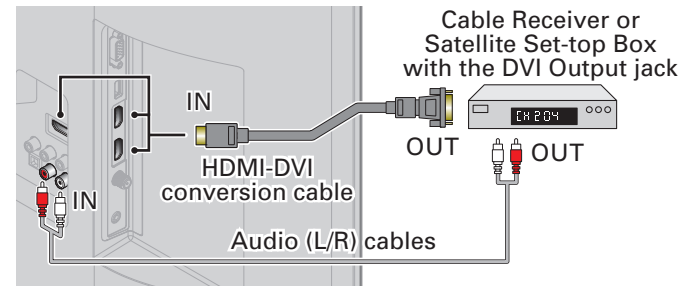

Note(s)

- Use an HDMI cable with the HDMI logo (a certified HDMI cable). High speed HDMI cable is recommended for the better compatibility.

For HDMI connection

- The unit accepts 480i / 480p / 720p / 1080i, 1080p 24/30/60Hz of video signals, 32kHz / 44.1kHz and 48kHz of audio signals.
- This unit accepts a 5.1 channel audio signal (Dolby Digital) and 2 channel audio signal (LPCM).
- If audio source is 7.1 channel audio signal (Dolby Digital) and user selects **Multichannel at Digital output format**, then the digital audio output will be 5.1 channel audio signal (Dolby Digital).
- This unit accepts only signals in compliance with EIA861.

For HDMI-DVI connection

- The unit accepts 480i, 480p, 720p, 1080i and 1080p video signals.
- HDMI-DVI connection requires separate audio connections as well and the audio signals are output as analog (L/R) audio.
- DVI does not display 480i image which is not in compliance with EIA/CEA-861/861B.

Component analog video connection

Component analog video connection offers better picture quality for video devices connected to the unit.

If you connect to the unit's component video (Y/Pb/Pr) input jacks, connect analog audio cables to the analog audio (L/R) input jacks.

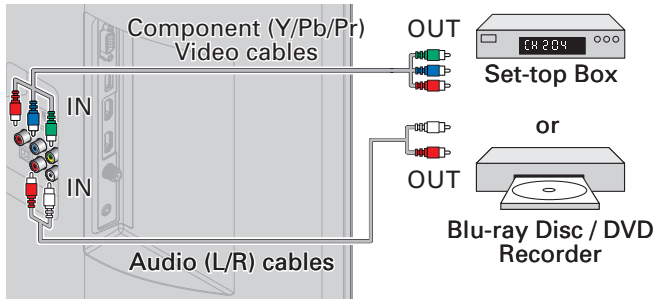

Note(s)

- The unit accepts 480i / 480p / 720p and 1080i of video signals for this connection.

Composite analog video connection

Composite analog video connection offers standard picture quality for video devices connected to the unit.

If you connect to the unit's component / composite video (Y/VIDEO) input jack (green), connect audio cables to the audio (L/R) input jacks. When the audio is monaural, then only connect to the audio L input jack.

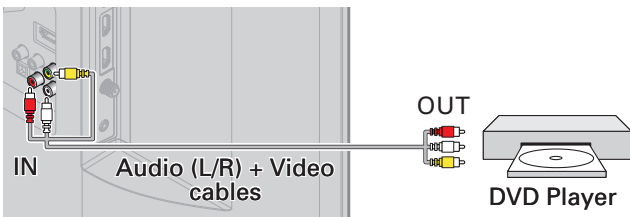

Note(s)

- With this unit, yellow cable must be connected to Y (green) jack on the component video input jacks.
- Whenever you connect to the composite video input jack (Y/VIDEO), you must disconnect the component video input jacks (Pb and Pr). If you leave those jacks connected, it may cause an unstable picture.

Digital audio output connection

If you connect this unit to an external digital audio device, you can enjoy multi-channel audio like 5.1ch digital broadcasting sound.

Use a digital audio optical cable to connect the unit to external digital audio devices.

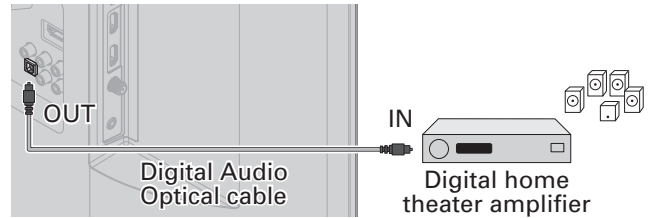

PC connection

HDMI connection

This unit can be connected to your PC that has an HDMI terminal. Use an HDMI cable for this digital connection.

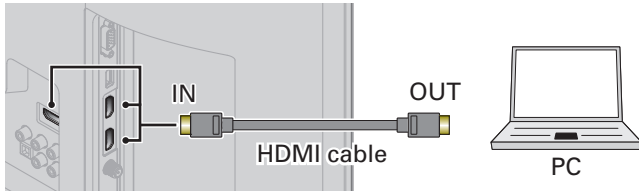

HDMI-DVI connection

This unit can be connected to your PC that has a DVI terminal. Use an HDMI-DVI conversion cable for this video digital connection and it requires stereo mini 3.5mm plug audio cable for analog audio signal as well.

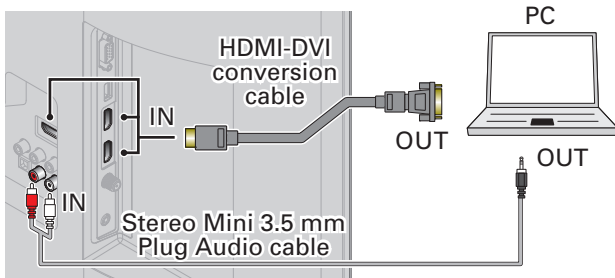

VGA connection

This unit is equipped with a PC input jack. If you connect this unit to your PC, you can use this unit as a PC monitor.

Use a VGA cable for this video connection and it requires a stereo mini 3.5mm plug audio cable for analog audio signal as well.

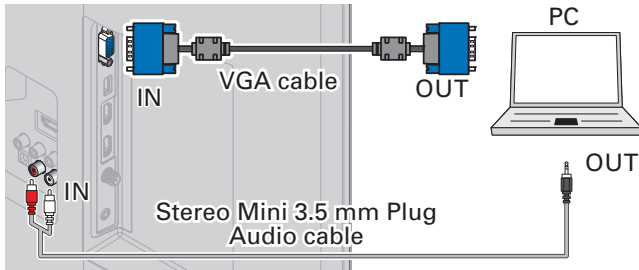

The following PC-input video signals can be displayed:

Format	Resolution	Refresh rate
VGA	640 x 480	60Hz
SVGA	800 x 600	
XGA	1,024 x 768	
WXGA	1,280 x 768	
	1,360 x 768	
FHD	1,920 x 1,080	

Other formats or non-standard signals will not be displayed correctly.

Note(s)

- Please purchase a VGA cable that has a ferrite core (0.6 inches (15mm) or more in diameter).
- Please purchase a HDMI-DVI conversion cable that has a ferrite core.
- The following operations may reduce noise.
 - Attach a ferrite core to the AC power cord of your PC.
 - Unplug the AC power cord and use the built-in battery of your portable / laptop PC.
- Use an HDMI cable with the HDMI logo (a certified HDMI cable). High speed HDMI cable is recommended for the better compatibility.
- The unit accepts 480i, 480p, 720p, 1080i and 1080p video signals.
- HDMI-DVI connection requires separate audio connections as well and the audio signals are output as analog (L/R) audio.
- DVI does not display 480i image which is not in compliance with EIA/CEA-861/861B.

USB memory stick

This unit offers easy playback of picture (JPEG) and video (Motion JPEG) files.

Insert the USB memory stick into the USB terminal shown below.

USB ➞ p. 31

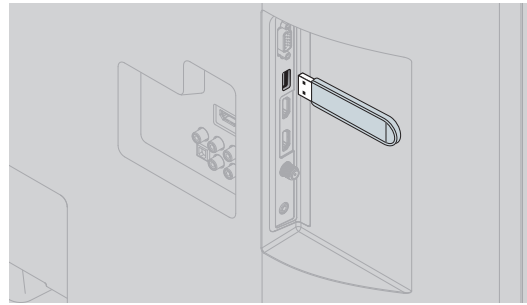

Note(s)

- The unit recognizes only a USB memory stick.
- Do not use a USB hub or an extension cable to connect an external hard disk drive to the unit. (Not supported.)
- Always insert a USB memory stick directly to this unit.
- A USB memory stick is not supplied with this unit.
- We do not guarantee that all USB memory sticks can be supported by this unit.
- Be sure to keep a backup copy of the original files on your USB device before you play them back on this unit. We have no responsibilities for damage or loss of your USB stored data.
- To protect your USB memory stick files from being erased place the write protect sliding tab in the protect position (if available).
- When you are ready to remove a USB memory stick, set the unit to go into standby mode to avoid any damage to your data and the unit.
- A USB memory stick that requires its own driver or the device with a special system such as fingerprint recognition are not supported.
- This unit is not allowed to use the USB memory stick which requires an external power supply (500mA or more).

*These operations are accessible by remote control.
Some may also be accessible by the main unit's control panel.*

Initial setup

This section will guide you through the unit's Initial setting which includes selecting a language for your On-screen menu and Autoprogram, which automatically scans and memorizes viewable channels.

Before you begin:

Make sure the unit is connected to an antenna or cable.

- 1 After making all the necessary connections, press to turn on the unit.
 - It may take a few moments to turn on the unit for the first time.
 - **Initial setup** menu appears automatically after the unit is turned on.
- 2 Use to select the On-screen language from the choices (English / Español / Français) on the right side of the TV screen, then press OK.
- 3 Use to select Voice guide to Off or On on the right side of the TV screen, then press OK.
- 4 Use to select **Antenna** for TV channels or **Cable** for CATV channels, then press OK.

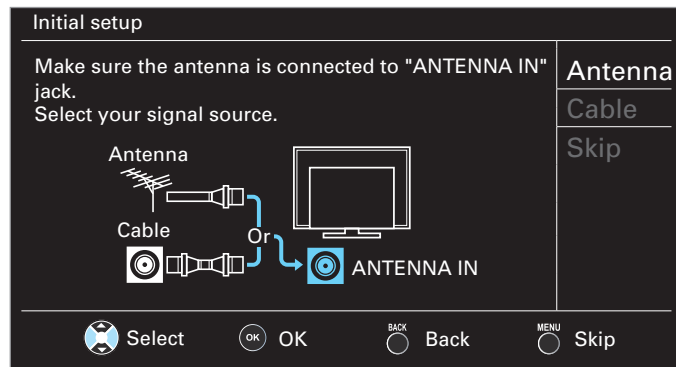

- When **Antenna** is selected, the TV detects antenna signals. It searches for DTV and analog TV channels available in your area.
- When **Cable** is selected, the TV detects signals supplied by cable. It searches for DTV, analog TV and cable channels available in your area.
- Autoprogram will begin.

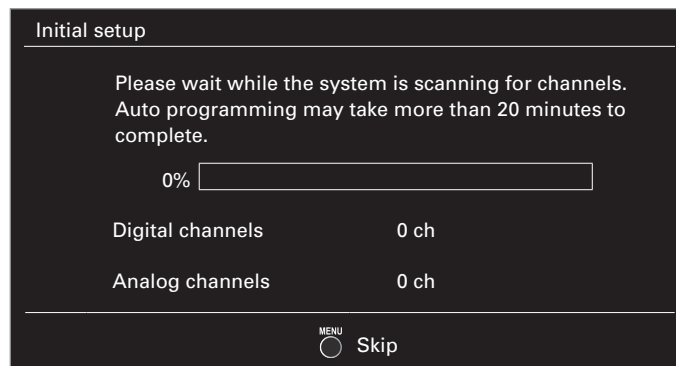

- 5 Use to select the desired location setting, then press OK. Home is the ENERGY STAR® qualified setting.

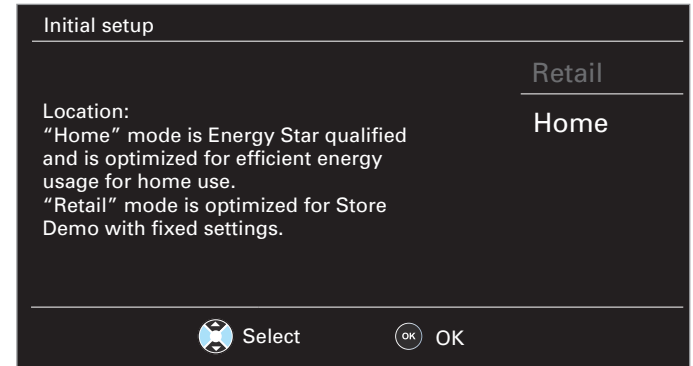

- Select **Home**, the unit is set to maximize the energy efficiency for home setting and it can be adjusted through a choice of picture and sound quality according to your preference. Use this setting to remove the E-sticker, if visible on the display. ➡ p. 30
- You must set **Home** in step 5. Otherwise, **Picture** and **Sound** settings you adjusted will not be memorized after the unit goes into standby mode.
- When the Initial setup is completed, the lowest memorized channel with the confirmation message of the location setting will be displayed on the TV screen.
- Select **Retail**, the unit will be set up with predefined settings for retail displays. In this setting, the power consumption may possibly exceed the limited requirement limit of the ENERGY STAR® qualification.

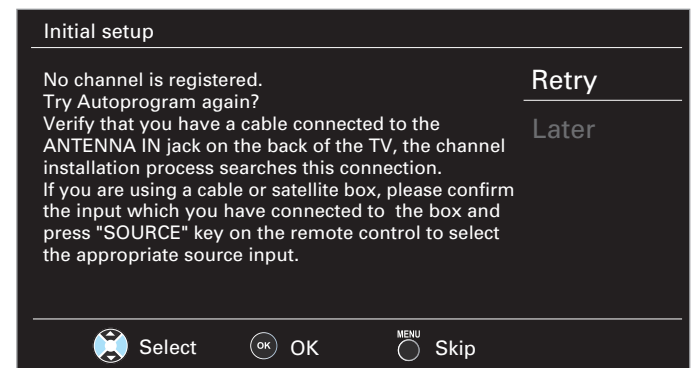
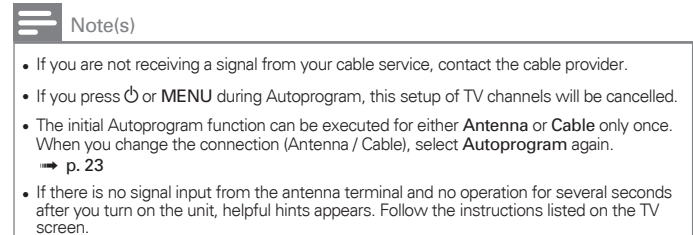

After an initial setup is completed...

- If you want to scan the channels automatically again. **Autoprogram** ➡ p. 23
- You can add the desired cable and analog channels not memorized by Autoprogram. **Add channels** ➡ p. 24
- If you want to change to another language. **Language** ➡ p. 31
- If you want to change the location setting. **Location** ➡ p. 30

3 Use your TV

Switching on your TV and putting it in standby mode

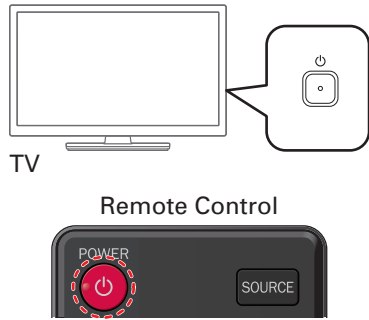

To turn the TV on from standby or off to standby

- Press on the unit or the remote control.

Note(s)

- Energy consumption contributes to air and water pollution. When the AC power cord is plugged in, your TV consumes energy with a very low standby power consumption.

Adjusting volume

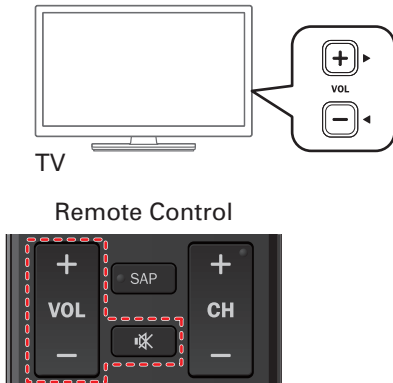

To decrease or increase volume

- Press **VOL** (-) / (+) on the unit or press **VOL** + / - on the remote control.
- VOL** (-) : Volume down
- VOL** (+) : Volume up

To mute or unmute sound

- Press on the remote control to mute the sound.
- Press again or **VOL** + / - to recover the original sound.

Switching channels

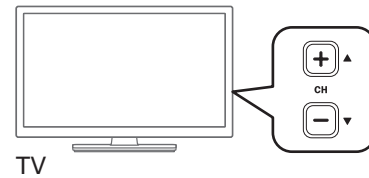

To select channels by using **CH** (-) / (+) or **CH** + / -

- Press **CH** (-) (down) / (+) (up) on the unit or press **CH** + / - on the remote control.

To select channels by using the **NUMBER** keys

Digital TV operation

- For digital channels, press a number followed by a dot "." and the corresponding sub channel number.
 - When selecting digital channel 11.1
Be sure to press • before entering the subchannel number.



Cable / NTSC (Analog) TV operation

- When selecting cable or analog channel 11



Press **PREV.CH** to return to the previously viewed channel.

Note(s)

- To select the non-memorized channels, use the **NUMBER** keys.
- No signal** will appear on the TV screen after the subchannel broadcast is over.
- Audio only program** message will appear on the TV screen, when you receive only a sound signal.

Watching channels from an external device

Switching each input mode can easily switch with the remote control between TV (DTV or analog TV) and external devices when they are connected to the unit.

1 Turn on the set-top box or the connected device.

- The picture from the set-top box or the connected device might appear automatically on the TV screen.

If the picture does not appear

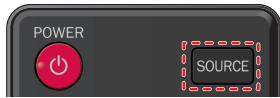

① Press **SOURCE** repeatedly to select the set-top box or the connected device and wait a few seconds between each selection until the picture appears.

- Pressing **▲** reverses the direction of the input modes.

e.g.)

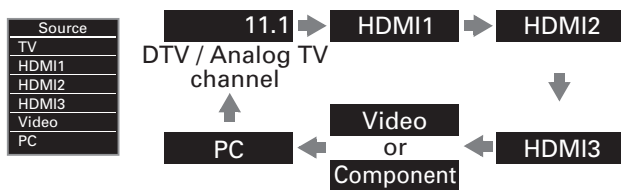

② Use the remote control for the set-top box or the connected device to select channels to view.

Changing picture and sound settings

1 Press **PIC/SOUND MODE** to set your TV to a predefined Picture and Sound setting.



2 Use **▲▼** to select one of the following settings :

Auto picture	Auto sound	Description
Personal		The customized settings you defined using the Picture and Sound menu
Standard		For normal TV viewing
Vivid		Enhanced picture contrast, sharpness and sound for viewing in a well-lit room
Sports		Brilliant picture settings and clear sound for high action
Movie		Deep picture and powerful sound settings for a cinematic experience
Game	–	Optimized for PCs and game consoles
Eco	–	Eco TV settings for low power consumption
–	Music	Optimized for music playback
–	News	Controls picture tone and sets the anchor's voice at a comfortable volume level

Sleep timer

Sleep timer can set the unit to go into standby mode after an incremental period of time.



Press **SLEEP** repeatedly to change the amount of time (increases the time by 30 minutes up to 120 minutes).

Sleep timer 120 min.

Press **SLEEP** once to call up the display for checking the remaining time.

- To cancel sleep timer, press **SLEEP** Repeatedly until Off is displayed.

Switching audio mode

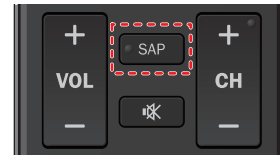

Digital TV operation

- Press **SAP** to display the currently selected language and the number of available languages.
- Press **SAP** repeatedly to cycle through the available audio languages.



Note(s)

- Available languages differ depending on the broadcast.
- Other** is displayed when the audio language cannot be acquired or the acquired languages are other than English, French or Spanish.

Cable / NTSC (Analog) TV operation

- Press **SAP** to display the currently selected audio mode.
- While receiving an MTS broadcast, press **SAP** repeatedly to cycle through the available audio channels.

11
SAP / STEREO

e.g.) When all audio modes are available



- Stereo** : Outputs stereo audio
- SAP** : Outputs a second audio program
- Mono** : Outputs mono audio

Create a list of favorite channels

You can create lists of your preferred TV channels so that you can find those channels easily.

- 1 Press **OK** while viewing a TV program.
- 2 Press **INFO** key to register channel to favorite list.
- 3 Use **▲▼** to select the desired channel, then press **OK** to add or remove on the list of favorite channels.
 - ☒ indicates that the channel is added.
 - ☐ indicates that the channel is removed.
- 4 Press **◀** to select list, then press **OK** to tune to channels.

Display the list of favorite channels

- 1 Press **OK** while viewing a TV program.
- 2 Use **▲▼** to select favorite channel, then press **OK** to tune to channels.

To edit the favorite list

- 1 Press **OK** while viewing a TV program.
- 2 Press **INFO** key to edit the favorite list.

To remove a channel from the favorite list

- 1 Use **▲▼** to select the desired channel, then press **OK** button.
- 2 Press **◀** to select list.

Changing Pix Shape

Display modes can be selected when your TV receives a 16:9 or 4:3 video signal.

Three types of display modes can be selected for a PC input signal.

Press **PIX SHAPE**  repeatedly to switch the TV aspect ratio.



For 16:9 video signal

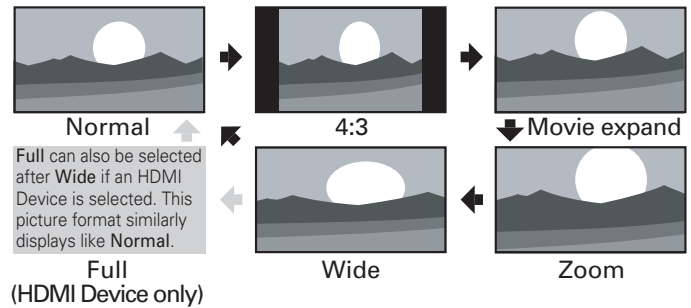

Normal	Original size.
4:3	Shortened horizontally. Sidebars appear on both edges of the screen.
Movie expand	Vertically stretched to fill the screen. This only crops out the top of the picture.
Zoom	Maximum size without changing its horizontal and vertical ratio.
Wide	Horizontally stretched picture. This crops out some of the left and right sides of the picture.

For 4:3 video signal

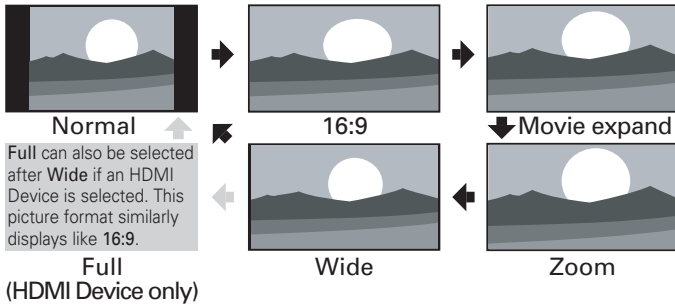

Normal	Original size. Sidebars appear on both edges of the screen.
16:9	Stretched horizontally to fill the screen.
Movie expand	Stretched more vertically at the top of the screen. This crops out the top of the picture.
Zoom	Maximum size that is more vertically stretched to fill the screen. This crops out some of the top and bottom of the picture.
Wide	Original size and the edges stretched horizontally to fill the screen.

For PC input signal

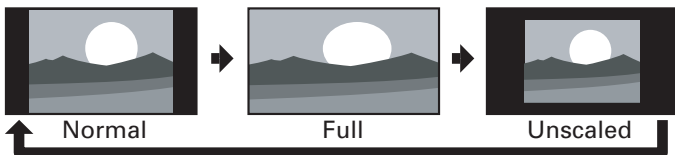

- This unit can also be connected to your PC that has a DVI terminal. Use an HDMI-DVI conversion cable for this video connection and it requires a stereo mini 3.5mm plug audio cable for analog audio signal as well.
- Refer to 16:9 video signal on this page if the PC has an HDMI output.

Normal	Proportionately stretched picture. Sidebars appear on both edges of the screen.
Full	Stretched out of proportion to fill the screen.
Unscaled	Original size.

TV screen information

You can display the currently selected channel or other information such as the aspect ratio on the TV screen.

In the digital mode, the detailed broadcasting information for the current off the air channel, such as program title, are displayed.

- Press INFO.

Digital TV operation

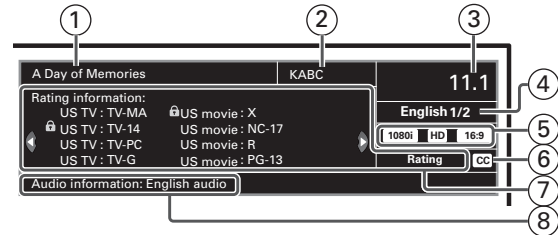

- Program title
- Broadcast station
- Channel number
- Audio language (DTV) / Audio mode (analog TV)
- Program's image aspect ratio
- CC (not available if Closed caption is set to Off)
- Child lock rating
- Audio information

Cable / NTSC (Analog) TV operation

- Channel number
- Switching channels → p. 16
- Audio language (DTV) / Audio mode (analog TV)
- Switching Audio Mode → p. 17
- Program's image aspect ratio
- Changing Pix Shape → p. 18
- CC (not available if Closed caption is set to Off)
- Caption settings → p. 25
- Child lock rating
- Child and Ratings Lock → p. 26

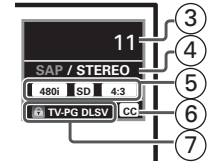

- Press INFO to hide the information.

Note(s)

- When the program guide consists of more than 4 lines, use ▲▼ to scroll to the next/previous lines.
- No description provided. is displayed when the program guide is not provided.
- While the TV screen information is displayed, the closed caption function is interrupted.
- In external input mode, the following screen is displayed; e.g.) When an external device is connected to video input jack.

Video

480i SD 4:3

TV-PG DLSV CC

The information display will automatically disappear in 5 seconds.

4 Making more use with your TV

This section describes the overview of the main menu displayed when you press **MENU**.

The main menu consists of the function setting items below.

Displaying the main menu

- 1 Press **MENU** to display the main menu.

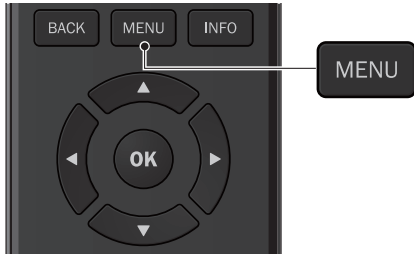

Picture	Auto picture	Personal
Sound	Backlight	18
Setup	Contrast	50
Features	Brightness	30
Language	Color	30
USB	Tint	0
	Sharpness	2
	Advanced settings	

- 2 Use **▲▼** to select the desired menu and an item, then press **OK** or use **▲▼◀▶** to determine the setting.

Picture

→ p. 21

Adjusting the picture mode or customize the picture quality as your preference.

Sound

→ p. 22

Adjusting the sound mode, equalizer and some other sound functions.

Setup

→ p. 23

Scanning the channels available in your area and see what the antenna signal levels are.

Features

→ p. 24

Adjusting the closed caption, parental guide and some other useful functions.

Language

→ p. 31

You can choose English, Spanish or French as your On-screen language.

USB

→ p. 31

You can view picture (JPEG) and video (Motion JPEG) files stored on a USB memory stick.

- 3 When the setting is completed, press **MENU** or **BACK** to exit.

Picture

Before you begin:

You must set **Home** in **Location**. ➡ p. 30

Otherwise, personalized picture and sound settings will not be memorized after the unit goes into standby mode.

1 Press **MENU** and use **▲▼** to select **Picture**, then press **OK**.

Picture	Auto picture	Personal
Sound	Backlight	18
Setup	Contrast	50
Features	Brightness	30
Language	Color	30
USB	Tint	0
	Sharpness	2
	Advanced settings	

2 Use **▲▼◀▶** to select the item you want to adjust, then press **OK**.

Auto picture	To select the desired setting, then press OK . (Personal , Standard , Vivid , Sports , Movie , Game or Eco) When you adjust the following settings, Personal picture will be set automatically when Location is set to Home .	
	◀ Cursor	Cursor ▶
Backlight	To reduce power consumption and reduce backlight brightness	To increase power consumption and brightness
Contrast	To decrease contrast	To increase contrast
Brightness	To decrease brightness	To increase brightness
Color	To decrease color intensity	To increase color intensity
Tint	To add red	To add green
Sharpness	To soften	To sharpen
Advanced settings	To select the desired setting, then press OK . (Color alignment , Noise reduction , Ambient light sensor , Black stretch , Dynamic contrast , Gamma , Film mode or BMR 120)	

Note(s)

- When the **Ambient light sensor** is set to **On**, it adjusts the backlight for the best picture quality by dynamically adjusting the backlight intensity in accordance with the room lighting condition. Please ensure the room lighting is stable and the light sensor is not blocked.

• You can set a particular picture quality using **Advanced settings**.

Picture	Color alignment	Normal
Sound	Noise reduction	Medium
Setup	Ambient light sensor	On
Features	Black stretch	On
Language	Dynamic contrast	On
USB	Gamma	Gamma2
	Film mode	Auto
	BMR 120	On

Color alignment	Color temperature mode	To set the picture color temperature to Personal (Cool , Normal or Warm) When you adjust the following settings, Personal picture will be set automatically when Location is set to Home .	
		◀ Cursor	Cursor ▶
	Red gain	To decrease red contrast	To increase red contrast
	Green gain	To decrease green contrast	To increase green contrast
	Blue gain	To decrease blue contrast	To increase blue contrast
	Red offset	To decrease red brightness	To increase red brightness
	Green offset	To decrease green brightness	To increase green brightness
	Blue offset	To decrease blue brightness	To increase blue brightness
Noise reduction	To select the desired setting, then press OK (Off , Minimum , Medium or Maximum)		
Ambient light sensor	Off	To set Ambient light sensor to Off	
	On	To adjust backlight for the best picture quality by dynamically adjusting the backlight intensity in accordance with lighting condition in the room	
Black stretch	Off	To set Black stretch to Off	
	On	To enhance black color	
Dynamic contrast	Off	To set Dynamic contrast to Off	
	On	To enhance contrast in an image automatically	
Gamma	Gamma1	To change the gamma setting (changes the brightness and contrast in the picture)	
	Gamma2		
	Gamma3		
Film mode	Off	To set Film mode to Off	
	Auto	To optimize the picture recorded by the original film	
BMR 120	Off	To set BMR 120 (Brilliant Motion Rate) to Off	
	On	To make the video appear smoother	

Sound

Before you begin:

You must set **Location** to **Home**. ➡ p. 30

Otherwise, personalized picture and sound settings will not be memorized after the unit goes into standby mode.

1 Press **MENU** and use **▲▼** to select **Sound**, then press **OK**.

Picture	Auto sound	Standard
Sound	Equalizer	
Setup	Virtual surround sound	On
Features	Auto volume leveling	Off
Language	TV speakers	On
USB	Digital output format	Multichannel
	Primary MTS	Stereo

2 Use **▲▼◀▶** to select the item you want to adjust, then press **OK**.

Auto sound	To select the desired setting, then press OK . (Personal , Standard , Vivid , Sports , Movie , Music or News) When you adjust the following settings (Equalizer , Virtual surround sound or Auto volume leveling), Personal sound will be set automatically when Location is set to Home .
-------------------	--

Adjust the tonal quality for each frequency.

Equalizer	Cursor ▼	Cursor ▲
	To adjust each level of tonal quality. Press BACK to go back to the previous menu.	

Virtual surround sound gives you the stereophonic virtual space through your existing 2-channel stereo system.

Virtual surround sound	Off	Natural effect
	On	Emphasized effect

This function keeps a constant loudness level between the TV commercials and the programs.

Auto volume leveling	Off	To remove the Auto volume leveling
	On	To reduce volume differences between the TV commercials and the programs

You can select the audio output from the unit's speakers or not. If your amplifier is HDMI link function compatible and connected by an HDMI cable to this unit, some sound operations such as volume up can be changed by using this unit's remote control.

TV speakers	On	To output sound from the unit's speakers
	Off	No output sound from the unit's speakers
	CEC Link	To control audio output from your connected HDMI-CEC compliant devices with VOL + / - by using this unit's remote control.

You can select audio output through a digital audio output connector.

Digital output format	Multichannel	To output multichannel signals (When the audio of the content is PCM, it will be output in PCM even if Multichannel is selected.)
	PCM	To output PCM format

You can set the output mode as a default for the sound mode (Analog TV only).

This setting is not interlocked when you change the output mode by pressing **SAP**. Refer to **Switching Audio Mode**. ➡ p. 17

Primary MTS	Stereo	To output stereo audio
	Mono	To output mono audio
	SAP	To output second audio program

Note(s)

- When Digital output format is configured for Multichannel output while content with Multichannel audio is being played, Voice guide (➡ p. 24) is not contained in the output.

Setup

Before you begin:

Make sure the unit is connected to antenna or cable.

- 1 Press **MENU** and use **▲▼** to select **Setup**, then press **OK**.

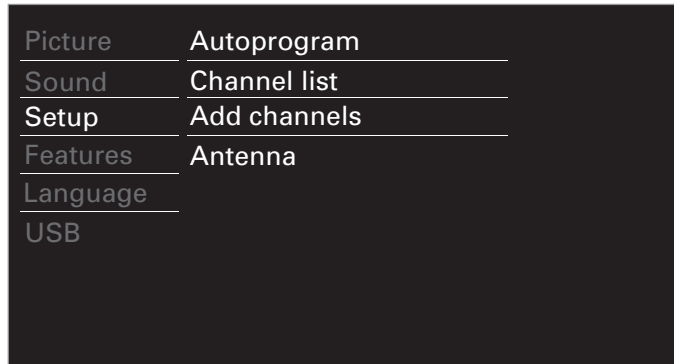

- 2 Adjust the following items.

Autoprogram

Be sure the RF cable is correctly connected to this unit and you are registered with your cable TV provider when you install cable channels.

- 1 Use **▲▼** to select **Autoprogram**, then press **OK**.
 - If you run **Autoprogram** when you have locked channels, a message appears asking to enter your PIN. Enter your child Lock PIN in order to complete the installation. (Default PIN code is **0, 0, 0, 0**.) You need to reset or set the channel lock again after the installation.
- 2 Use **▲▼** to select an appropriate option, then press **OK**.
 - When **Antenna** is selected, the TV detects any Off-the-Air antenna signals. It searches for ATSC (Digital) and NTSC (Analog) channels available in your area.
 - When **Cable** is selected, the TV detects signals supplied by cable. It searches for ATSC (Digital), NTSC (Analog) and Cable channels available in your area.

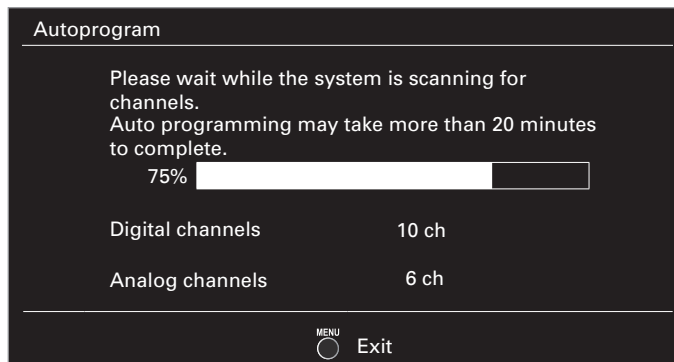
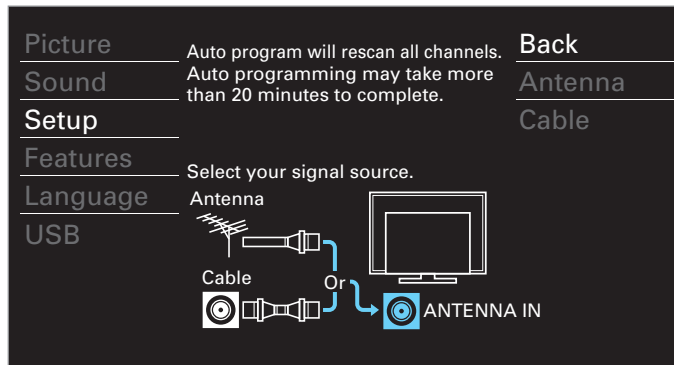

- When the scanning and memorizing of available channels is completed, the lowest memorized channel will be displayed.

Note(s)

- After setting **Autoprogram**, using **CH + / -** skips unavailable channels automatically.
- If you are not receiving a signal from your cable service, contact the cable provider.
- If you press **○** or **MENU** during Autoprogram, the setup of TV channels will be cancelled.
- Even if **Autoprogram** is completed, the channel setting will be lost if the AC power cord is unplugged before the unit goes into standby mode by pressing **○**.
- The PIN code will be required once you set a PIN code in the **Child and Ratings Lock**. → p. 26
- If you want to change your PIN code, follow the instruction for **Change PIN**. → p. 28

Channel list

The channels selected in the **Channel list** can be skipped when selecting the channels using **CH + / -**.

These channels can still be selected with the **NUMBER** keys.

- 1 Use **▲▼** to select **Channel list**, then press **OK**.
- 2 Use **▲▼** to select the channel you want to remove, then press **OK**.

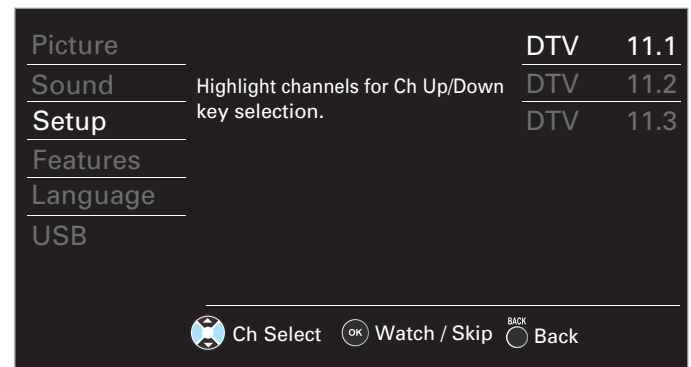

- The channel display for the removed channel darkens. You will not be able to select the channel again using **CH + / -**.
- To reactivate a removed channel, use **▲▼** and press **OK**. The registered channels are highlighted.
- When you remove a main channel, its subchannels are removed as well.

Note(s)

- The channel with **DTV** indicated on the display is digital TV (ATSC). Otherwise the channel is analog TV (NTSC).

Add channels

This function lets you add the off the air analog TV or analog cable channels that were not added by the Autoprogram due to reception conditions during the initial setting.

- 1 Use ▲▼ to select **Add channels**, then press OK.
- 2 Use the **NUMBER** keys to enter the number of the channel you want to add, then press OK.

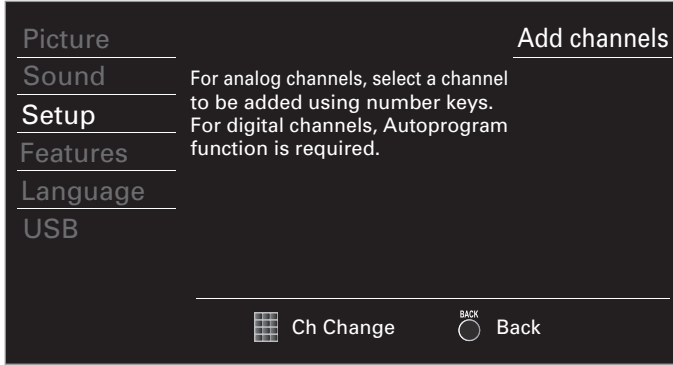

Note(s)

- If Setup completes successfully, **Added to the channel list** is displayed.
- If External Input is used, it is not possible to register the channel and **Unavailable** will be displayed on the TV screen.
- Some channels cannot be selected by CH + / - . Use the **NUMBER** keys to select the non-memorized channel list channels.

Antenna confirmation

Digital TV operation

This function lets you check the digital signal strength of each channel.

- 1 Use ▲▼ to select **Antenna**, then press OK.
- 2 Use the **NUMBER** keys or CH + / - to select the channel for which you want to check the digital signal strength.

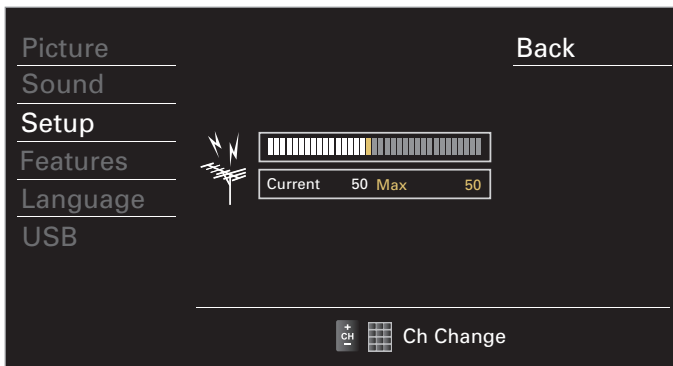

Note(s)

- If the channel is set to an analog channel or external input, you cannot confirm the antenna condition.

Features

- 1 Display **Setup** using Home Menu and use ▲▼ to select **Features**, then press OK.

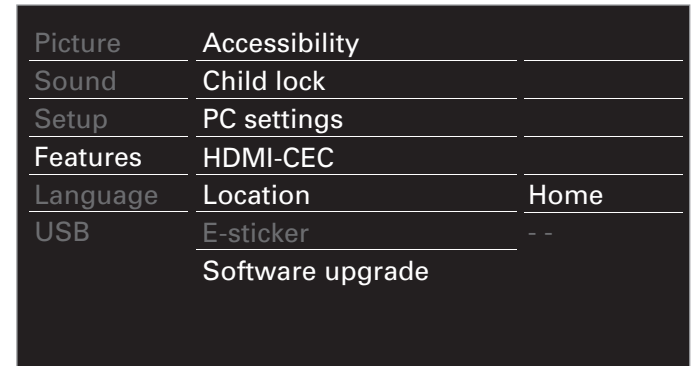

- 2 Adjust the following items.

Accessibility

- 1 Use ▲▼ to select **Accessibility**, then press OK.

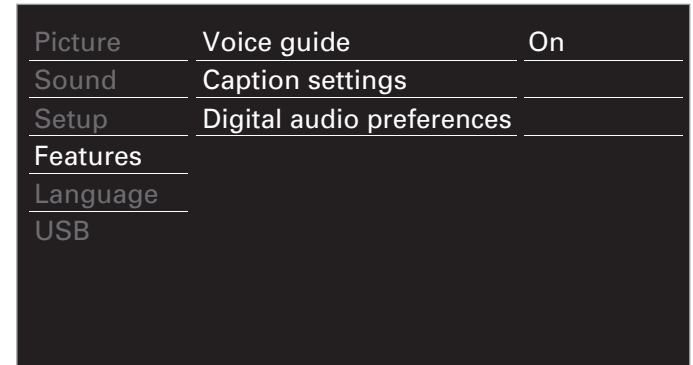

- 2 Adjust the following items.

Voice guide

Lets you configure voice guide and its settings.

- 1 Use ▲▼ to select **Voice guide**, then press OK.

Voice guide	Off	To set Voice guide off
	On	To set Voice guide on

Note(s)

- When Digital output format is configured for Multichannel output while content with Multichannel audio is being played, Voice guide is not contained in the output.

Caption settings

Closed captions displays the audio portion of the program as superimposed text over the video.

- 1 Use ▲▼ to select **Caption settings**, then press **OK**.

Picture	Closed captions	Off
Sound	Caption service	CC-1
Setup	Digital caption service	CS-1
Features	Caption style	
Language		
USB		

- 2 Use ▲▼◀▶ to select the feature you want to use, then press **OK**.

You can choose the closed caption display.

Closed captions	Off	Closed caption is not displayed.
	On	Closed caption is always displayed.
	CC w/ mute	Closed caption is displayed when the sound is off.

Digital TV operation

In addition to the basic closed caption, DTV has its own closed caption called digital caption service. Use this menu to change the settings for digital caption service.

Digital caption service	CS-1 to CS-6	Select one of these before changing any other item in Caption settings menu. Choose CS-1 under normal conditions.
-------------------------	--------------	---

Cable / NTSC (Analog) TV operation

Caption service	CC-1 and T-1	The primary closed captions and text services. The closed captions or text is displayed in the same language as the program's dialog (up to 4 lines of script on the TV screen).
	CC-3 and T-3	Serve as the preferred data channels. The closed captions or text is often a secondary language.
	CC-2, CC-4, T-2 and T-4	Rarely available and broadcasters use them only in special conditions, such as when CC-1 and CC-3 or T-1 and T-3 are not available.

- There are 3 display modes according to programs:

Paint-on	Displays characters on the TV screen immediately.
Pop-on	Once characters are stored in memory, they are displayed all at once.
Roll-up	Displays the characters continuously by scrolling (max. 4 lines).

You can choose the font (size, color, etc), background and other characteristics of the closed captions text.

Caption style	Font	Font style	Closed captioning font style, size, color and transparency (opacity) can be changed.
		Font size	
		Font color	
		Font opacity	
	Background	Background color	Background color and transparency (opacity) of the displayed caption can be switched.
		Background opacity	
	Edge	Edge color	Edge color and type of the displayed caption can be switched.
		Edge type	

Picture display



- Review your setting choice made above by looking in the upper right corner of the displayed setting box (not all selections show the differences selected).

Note(s)

- Closed caption will NOT be displayed when you are using an HDMI connection.
- **Digital caption service** that you can switch differs depending on the broadcast format.
- Caption style will not have any effect if the User setting is set to Off.
- Closed captions service may not be controlled by this unit's menu options if you are watching television through a set-top box. In which case you will need to use the menu options on the external set-top box to control closed captions.
- The captions do not always use correct spelling and grammar.
Not all TV programs and product commercials include closed captions information. Refer to your area TV program listings for the TV channels and times of closed captions shows. The closed captions programs are usually noted in the TV listings with a service mark such as CC.
- Not all closed captions services are used by a TV broadcaster during the transmission of a closed caption program.
- To show the closed caption on your TV screen, broadcast signal must contain the closed caption data.
- Captions and texts may not exactly match the TV voice.
- Changing channels may delay the closed caption for a few seconds.
- Adjusting or muting the volume may delay the closed caption for a few seconds.
- Abbreviations, symbols and other grammatical shortcuts may be used in order to keep pace with the on-screen action. This is not a malfunction.
- The caption or text characters will not be displayed while the main menu or functions display is shown.
- If a black box appears on the TV screen, this means that the closed caption is set to the text mode. To clear the box, select CC-1, CC-2, CC-3, or CC-4.
Refer to **Caption settings** → p. 25
- If the unit receives poor quality television signals (mainly when the analog (NTSC) is received), the captions may contain errors or there might be no captions at all. Some possible causes of poor quality signals are:
 - Automobile ignition noise
 - Electric motor noise
 - Weak signal reception
 - Multiplex signal reception (ghosts or screen flutter)
 - Data dropout and Pixelation (for DTV only)
- The unit retains the closed caption setting if the power fails.
- When the unit receives special effects playback signal (e.g. search, slow and still) from a VCR's video output channel (ch3 or ch4), the unit may not display the correct caption or text.
- The EUT (Equipment Under Test) setting that satisfies § 79.102 (e) is as follows:
 - Font: Mono-font
 - Character size: Large

Child and ratings lock

You can prevent your children from watching certain programs or certain channels by locking the TV controls and by using ratings.

1 Use ▲▼ to select **Child lock**, then press OK.

Picture	Accessibility	
Sound	Child lock	
Setup	PC settings	
Features	HDMI-CEC	
Language	Location	Home
USB	E-sticker	- -
Software upgrade		

2 Use the **NUMBER** keys to enter the 4-digit numbers for your PIN code.

- When you have not set up your PIN code, enter 0, 0, 0, 0.
- When the PIN code is correct, **Child lock** menu is displayed.

See the following description for setting each item.

Picture	Channel lock
Sound	US movie ratings lock
Setup	US TV ratings lock
Features	Canadian English rating
Language	Canadian French rating
USB	Region ratings lock
	Clear region ratings lock
	Change PIN

Digital audio preferences

You can set the interpretive broadcasting by an audio explanation.

1 Use ▲▼ to select **Digital audio preferences**, then press OK.

Digital audio preferences	Accessibility	To prioritize VI-Visually Impaired streaming or HI-Hearing Impaired streaming: The setting for handicapped users (Main audio , Visually Impaired or Hearing Impaired).
	Audio language	To set your preferred language in the audio streaming (English , Spanish or French).
	Primary audio selection criteria	To set TV priority based on either of the above settings: (Accessibility or Audio language).

Note(s)

- When you select a rating and set it to ☒ or ☐, the higher ratings will be blocked automatically. The lower ratings will be available for viewing.
- When you set the highest rating to ☐, all ratings turn to ☐ automatically.
- To block any inappropriate programs, set your limits in **US movie ratings lock**, **US TV ratings lock** and **Region ratings lock**.
- The child lock setting will be retained after a power failure or after the power is removed for longer than 10 seconds (except the PIN code reverts to 0000).
Child and ratings lock → p. 26
- **Region ratings lock** and **Clear region ratings lock** will be available when the unit receives a digital broadcast using the new rating system.
- For the United States, the unit may download the region ratings lock table, if required.
- The Canadian rating systems on this unit are based on CEA-766-A and CRTC policy.

Channel lock

Particular channels or external input modes can be invisible in this function.

- 3 Use ▲▼ to select **Channel lock**, then press **OK**.
- 4 Use ▲▼ to select the particular channels or external input, then press **OK** repeatedly to switch between block and view.
 - ☐ indicates that the channel or input source is not locked (Viewable).
 - ☒ indicates that the channel or input source is locked (Blocked).

Picture	<input type="checkbox"/> HDMI1
Sound	<input type="checkbox"/> HDMI2
Setup	<input type="checkbox"/> HDMI3
Features	<input type="checkbox"/> Component / Video
Language	<input type="checkbox"/> PC
USB	<input type="checkbox"/> 40.1 DTV
	<input type="checkbox"/> 40.2 DTV
	<input checked="" type="checkbox"/> 40.3 DTV

Setting US movie and TV ratings

US movie ratings lock is the rating system created by MPAA. US TV ratings lock has controlled access to individual programs based on their age and content rating.

- 3 Use ▲▼ to select **US movie ratings lock** or **US TV ratings lock**, then press **OK**.
- 4 Use ▲▼ to select the desired rating, then press **OK** repeatedly to switch between block and view.
 - For US TV ratings, you can further set the sub ratings to block specific elements within programs.
 - ☐ indicates that the rating is not locked (Viewable).
 - ☒ indicates that the rating is locked (Blocked).
 - ☒ indicates that the sub rating is locked (Blocked).

US movie ratings lock

Picture	<input type="checkbox"/> All
Sound	<input checked="" type="checkbox"/> NR
Setup	<input type="checkbox"/> G
Features	<input type="checkbox"/> PG
Language	<input type="checkbox"/> PG-13
USB	<input type="checkbox"/> R
	<input type="checkbox"/> NC-17
	<input type="checkbox"/> X

US TV ratings lock

Picture	<input type="checkbox"/> All
Sound	<input checked="" type="checkbox"/> None
Setup	<input type="checkbox"/> TV-Y
Features	<input type="checkbox"/> TV-Y7
Language	<input type="checkbox"/> TV-G
USB	<input type="checkbox"/> TV-PG
	<input type="checkbox"/> TV-14
	<input type="checkbox"/> TV-MA

US movie ratings	US TV ratings	Description
All		All ratings locked including no rating
NR	None	No rating
–	TV-Y	Appropriate for all children
–	TV-Y7	Appropriate for all children 7 and older
G	TV-G	General audience
PG	TV-PG	Parental guidance suggested
PG-13	–	Unsuitable for children under 13
–	TV-14	Unsuitable for children under 14
R	–	Restricted under 17 requires accompanying parent or adult guardian
NC-17	–	No one under 17 admitted
X	TV-MA	Mature audience only

To set the sub ratings (displayed in the right column)

As for TV-Y7, TV-PG, TV-14 or TV-MA, you can further set the sub ratings to block specific elements within programs. To set the sub ratings, follow the step below.

Use ▲▼◀▶ to select the desired rating, then press OK repeatedly to switch between ☒ and ☐.

- ☐ indicates in the right column that the sub rating is not locked (Viewable).
- ☒ indicates in the right column that the sub rating is locked (Blocked).
- ☒ indicates in the middle column that all the sub ratings are locked (Blocked).
- ☒ indicates in the middle column that one or more, but not all of the sub rating(s) are locked (Blocked).

Picture	<input type="checkbox"/> All	<input checked="" type="checkbox"/> (D)Dialog
Sound	<input type="checkbox"/> None	<input checked="" type="checkbox"/> (L)Language
Setup	<input type="checkbox"/> TV-Y	<input type="checkbox"/> (S)Sex
Features	<input type="checkbox"/> TV-Y7	<input type="checkbox"/> (V)Violence
Language	<input type="checkbox"/> TV-G	
USB	<input checked="" type="checkbox"/> TV-PG	
	<input type="checkbox"/> TV-14	
	<input type="checkbox"/> TV-MA	

US TV ratings	Sub rating
TV-Y7	(FV)Fantasy Violence
TV-PG	(D)Dialog (L)Language
TV-14	(S)Sex (V)Violence
TV-MA	(L)Language (S)Sex (V)Violence

Note(s)

- Blocked sub rating will appear beside the main rating category in US TV ratings lock menu.
- You cannot block a sub rating if the main rating is set to ☐.
- Changing the category to ☒ or ☐ automatically changes all its sub ratings to the ☒ or ☐.

Canadian English or Canadian French ratings

You can select the rating for Canadian English or Canadian French broadcasting.

3 Use ▲▼ to select Canadian English rating or Canadian French rating, then press OK.

4 Use ▲▼ to select the desired rating, then press OK repeatedly to switch between block and view.

- ☐ indicates that the rating is not locked (Viewable).
- ☒ indicates that the rating is locked (Blocked).

Canadian English rating	Canadian French rating	Description
All		Locked all ratings
E		Exempt program
C	–	For all children
C8+	–	For all children 8 and older
G		General audience
–	8ans+	Unsuitable for ages under 8
PG	–	Parental guidance suggested
–	13ans+	Unsuitable for ages under 13
14+	–	Unsuitable for ages under 14
–	16ans+	Unsuitable for ages under 16
18+	18ans+	Adult audience only

Note(s)

- The V-Chip can block non rated programs as per "CEA-608-E sec. L.3". If the option to block NR, None or E programs are used in US movie ratings lock, US TV ratings lock, Canadian English rating or Canadian French rating accordingly "unusual results may occur and the unit may not receive emergency bulletins or other types of programming": / Emergency bulletins (Such as EAS messages, weather warnings and others) / Locally originated programming / News / Political / Public service announcements / Religious / Sports / Weather.

Change PIN

Although the default PIN code (0000) is supplied with the unit, you can set your own PIN code.

3 Use ▲▼ to select Change PIN, then press OK.

4 Press the NUMBER keys to enter the new 4-digit PIN code.

- Enter PIN code again in Confirm PIN. entry field.

Picture	<div>Enter PIN.</div> <div>- - - -</div> <div>Confirm PIN.</div> <div>- - - -</div>
Sound	
Setup	
Features	
Language	
USB	
<div>PIN Code</div> <div>BACK Back</div>	

Note(s)

- Make sure to enter a PIN code and the confirm PIN code must be exactly the same. If they are different, the space is cleared to reenter the new PIN code.
- When a power failure occurs the PIN code will be erased and unit returns to the default PIN code (0000).
- If you forget the PIN code, unplug the AC power cord then wait for 10 seconds to plug the AC power cord in again. The unit will restore the PIN code to 0000 (factory default). Then repeat the change PIN procedure to setup a new PIN code.

PC settings

This function lets you adjust the PC screen position, clock and phase during PC input.

Use ◀▶ to adjust **Clock** setting to stabilize the PC screen and **Phase** setting to improve the clarity of the PC screen.

1 Use ▲▼ to select **PC settings**, then press **OK**.

Picture	Auto adjustment	
Sound		
Setup	Horizontal position	0
Features	Vertical position	0
Language	Clock	0
USB	Phase	0

2 Use ▲▼ to select the item you want to adjust, then press **OK**.

- The horizontal / vertical position, clock and phase of the PC screen are automatically adjusted.

Auto adjustment	Select if you want to adjust automatically.	
	◀ Cursor	Cursor ▶
Horizontal position	To move PC screen left	To move PC screen right
Vertical position	To move PC screen down	To move PC screen up
Clock	To decrease setting value	To increase setting value
Phase		

Note(s)

- You may not obtain an appropriate screen with **Auto adjustment** for some signals. In this case, please adjust the settings manually.
- Properly adjust the **Clock** setting and then adjust the **Phase** setting.

HDMI-CEC

This function allows you to operate the linked functions between our brand devices with an HDMI-CEC feature and this unit connecting through an HDMI cable. You must connect this unit to our brand HDMI-CEC devices and be sure it's HDMI-CEC setting is also set to On.

1 Use ▲▼ to select **HDMI-CEC**, then press **OK**.

Picture	HDMI-CEC Control	On
Sound	Auto device off	On
Setup	Auto TV on	On
Features	Device list	
Language		
USB		

2 Use ▲▼◀▶ to select the item you want to adjust, then press **OK**.

Set the HDMI-CEC control **On** or **Off**. The following additional settings will be grayed out when you set them to **Off**.

HDMI-CEC control	Off	Disables all HDMI-CEC.
	On	Selects if you have connected an external device that is compatible with the HDMI-CEC function.

You can set your connected HDMI-CEC device to turn off by interlocking from this unit's power.

Auto device off	Off	Your connected HDMI-CEC device stays on even if the unit goes into standby mode.
	On	Your connected HDMI-CEC device turns off automatically when the unit goes into standby mode.

This unit will turn on when the power on signal is sent from your connected HDMI-CEC device.

Auto TV on	Off	This unit stays in standby mode even if you turn on your connected HDMI-CEC device.
	On	This unit turns on automatically when you turn on your connected HDMI-CEC device.

Note(s)

- Some set-top boxes are not compatible with **HDMI-CEC**, this is not a malfunction.

Device list

This function lets you see the product model number or name of connected devices.

Use ▲▼ to select the desired HDMI-CEC devices listed on the TV screen, then press **OK**.

Your connected HDMI-CEC device will be turned on if this device is in standby mode.

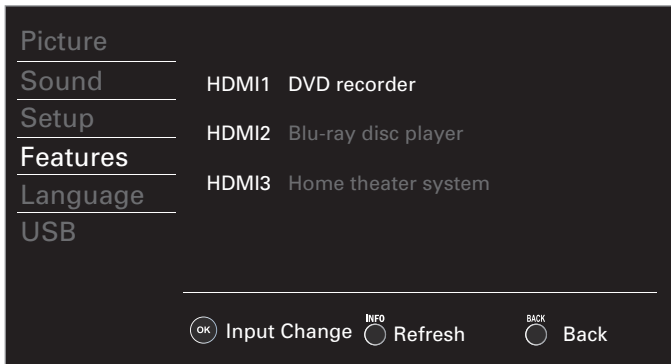

Setting your location to home

You can set the **Location** of your TV to **Home** or **Retail**. Choosing **Home** gives you full flexibility to change predefined settings for picture and sound.

1 Use ▲▼ to select **Location**, then press **OK**.

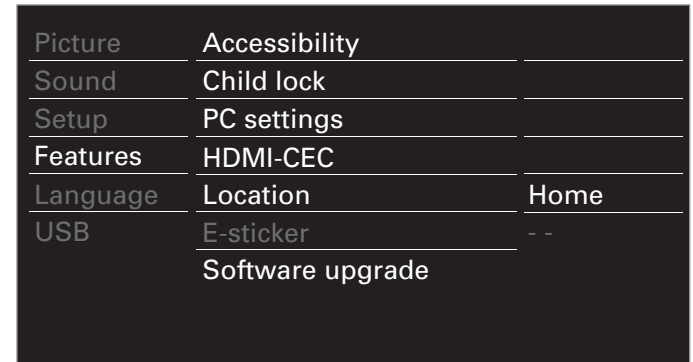

2 Use ▲▼ to select **Home** or **Retail**, then press **OK**.

Retail	The unit will be set up with predefined settings for retail displays. In this setting, the power consumption may possibly exceed the limit requirement of the ENERGY STAR® qualification.
Home	This setting is ENERGY STAR® qualified. The unit is set to maximize the energy efficiency for home setting and it can be adjusted through a choice of picture and sound quality selections according to your preference.

Note(s)

- You must set **Home** in the menu. Otherwise, personalized picture and sound settings will not be memorized after the unit goes into standby mode.

E-sticker

When you set **Location** to **Retail** store, E-sticker (Electronic Sticker) is displayed. E-sticker can be turned off using procedure below.

1 Use ▲▼ to select **E-sticker**, then press **OK**.

2 Use ▲▼ to select **Off**, then press **OK**.

Off	You can turn off E-sticker.
Top	E-sticker is displayed on top of the TV screen.
Bottom	E-sticker is displayed on bottom of the TV screen.

Note(s)

- If you set **Location** to **Home**, E-sticker will not be displayed.

Language

- 1 Press **MENU** and use ▲▼ to select **Language**, then press **OK**.

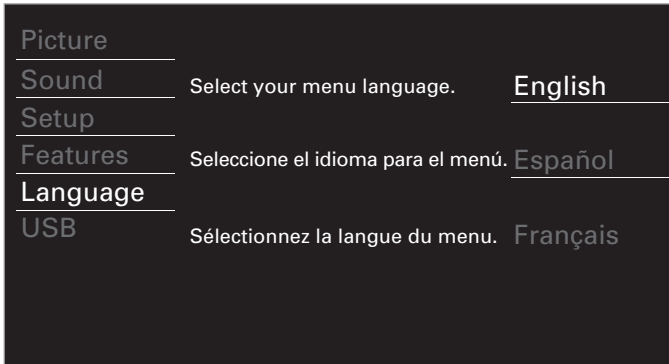

- 2 Use ▲▼ to select **English**, **Español** or **Français**, then press **OK**.

Note(s)

- If you need the English menu instead of the Spanish or French menu's, press **MENU**. Use ▲▼ to select **Idioma** or **Langue**, then press **OK**. Use ▲▼ to select **English** then press **OK**. Press **MENU** to exit the main menu.

USB

Your TV is fitted with a USB connection that enables you to view JPEG photos or watch Motion JPEG files stored on a USB memory stick.

- 1 Connect the USB memory stick to the USB terminal on the back of your TV.
- 2 Press **MENU** and use ▲▼ to select **USB**, then press **OK**.
 - The highlighted text will move to **Start now**, then press **OK** again.

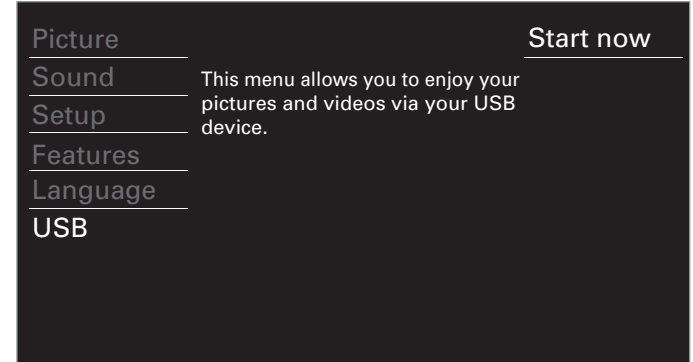

- 3 Use ▲▼ to select the **Picture** or **Video**, then press **OK**.

- These recorded files must meet specifications shown below:

Picture (JPEG)	Upper limit	4000 x 4000 pixels	
Video (Motion JPEG)	Size	320 x 240 (QVGA)	
	Frame rate	30fps	
	Audio type	LPCM	Sampling frequency (32 kHz, 44.1 kHz or 48 kHz) Quantization bit rate (16 bit)

Note(s)

- Up to 2GB (FAT16) or 8GB (FAT32) capacity can be supported.
- Up to 10,000 files or 1,000 folders with 19 hierarchies can be recognized.
- Up to 255 English characters can be recognized.
- This unit does not support MTP (Media Transfer Protocol).
- This unit supports FAT16 and FAT32 file systems.
- If the file is not supported, an error message appears.
- When the USB memory stick is not recognized, try reconnecting it again.
- We cannot be held responsible if your USB memory stick is not supported, nor will we accept any liability for damage or loss of stored data.
- To protect your USB memory stick files from being erased place the write protect sliding tab in the protect position (if available).
- Be sure to keep a backup copy of the original files on your device before you play them back on this unit.
- This unit does not recognize USB memory stick that requires a special driver.
- This unit is not allowed to use the USB memory stick which requires an external power supply (500mA or more).
- A file name exceeding 128 characters or contains a dot character is not supported on this TV.
- Progressive JPEG files are not supported.
- Only a Motion JPEG file with an ".avi" extension is supported. An extension ".mov" is not supported.
- During Motion JPEG playback, "Pause", "Forward" and "Reverse" do not work on this unit.

Picture (JPEG)

1 Use ▲▼ to select the desired file, then press OK.

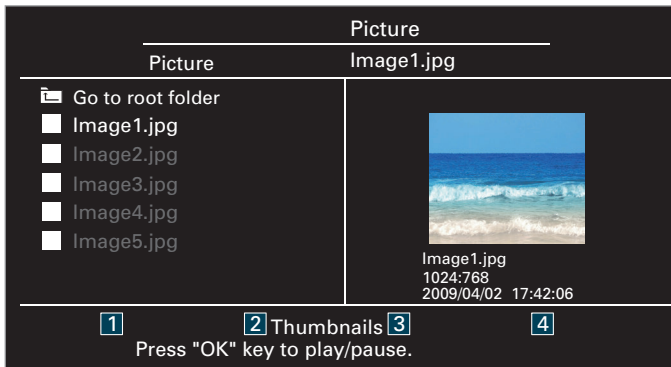

- To toggle between List and Thumbnails press the **NUMBER 2** key each time.
- The unit goes to the slide show automatically.
To pause / play the slide show, press **OK**.
- Use the **NUMBER keys** (1 through 4) to see the file details (**1**) or change the following settings (**2 ~ 4**).

See the description in table below.

Item	Detail
1 More detail	Press 1 to display file details below. Name, Album, Date, Size or Next . Press 1 again to remove file details.
4 Start show	Press 4 or OK to start the slide show. While the slide show is on, the following 2 settings will be displayed.
2 Transitions	Press 2, then use ▲▼ to select the transition mode choosing from; None, Dissolve, Wipe right, Wipe left, Wipe up, Wipe down, Box in or Box out .
3 Slide time	Press 3, then use ▲▼ to change the display time choosing from; Short, Medium or Long .
4 Stop show	Press 4 or OK to stop the slide show. While the slide show is off, the following 2 settings will be displayed.
1 Repeat	Press 1, then use ▲▼ to select the repeat mode choosing from; Off, One or All .
2 Rotate	Every press on 2 will turn the picture clockwise by 90 degrees.
3 Zoom	Press 3, then use ▲▼ to select the zoom factor (1x, 2x or 4x). Press OK to set the zoom factor.

Video (Motion JPEG)

1 Use ▲▼ to select the desired file, then press OK.

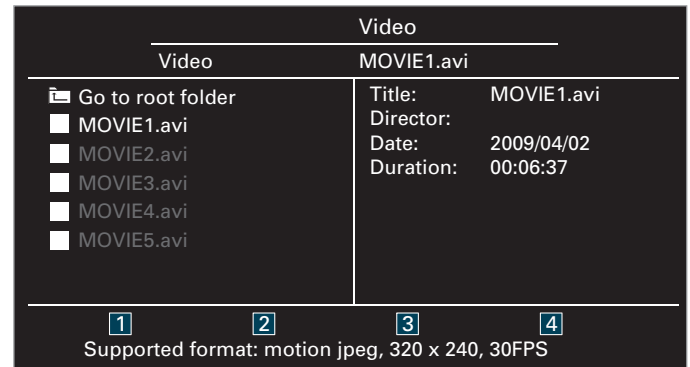

- To stop playback and return to the file list, press **BACK**, **OK** or **CH +**.
- Press **CH -** to play back from the beginning.

Item	Detail
1 More detail	Press 1 to display file details below. Title:, Director:, Date: and Duration:. Press 1 again to remove file details.

5 Upgrade your TV software

SANYO continuously tries to improve its products and we strongly recommend that you upgrade the TV software when upgrades are available.

New software can be downloaded from our website at sanyo-av.com/support/download using the model number of your TV to find information.

Checking your current software version

- 1 Press **MENU** and use **▲▼** to select **Features**, then press **OK**.
- 2 Use **▲▼** to select **Software upgrade**, then press **OK**.

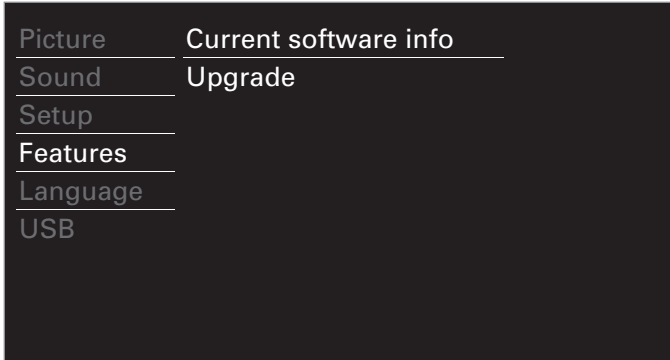

- 3 Use **▲▼** to select **Current software info**, then press **OK**.
 - The version and a description of the current software is displayed.

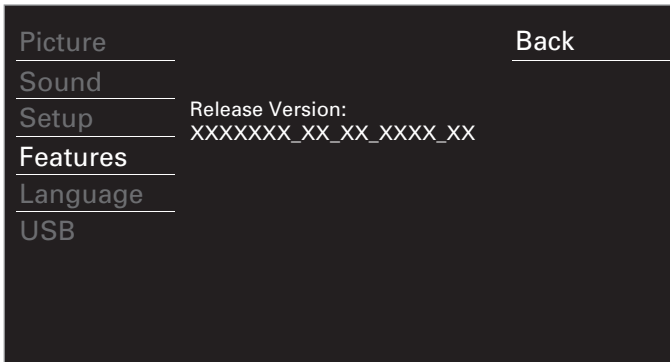

Upgrading the software

You can upgrade the software by using a USB memory stick.

Preparing for the software upgrade

You require the following equipment :

- A PC with web browsing capability.
- An archive utility that supports the ZIP-format (e.g. WinZip for Windows or Stuffit for Mac OS).
- A blank empty clean formatted USB memory stick.

Note(s)

- Only FAT / DOS-formatted portable memory is supported.
- Use only software upgrades that can be found on the SANYO website.

Downloading the software

Find information and software related to your TV and download the latest software upgrade file to your PC.

- 1 On your PC, open a web browser and go to sanyo-av.com/support/download
- 2 Enter the model number in the "Type the Model Number..." field.
- 3 Click the desired software to be downloaded.
 - Decompress the ZIP-file.
- 4 Copy the upgrade file to the empty root directory on the clean formatted USB memory stick.

Starting the software upgrade



Warning

- When the software upgrade is running, don't press any keys.
- Do not remove the USB memory stick during the software upgrade.
- If an error occurs during the upgrade, retry the procedure or for further assistance, please contact the call center.

- 1 Connect your USB memory stick with the upgrade file to the USB service port on the back of your TV. Use only the unit's side panel keys to enter the following instruction Steps 2 to 6.

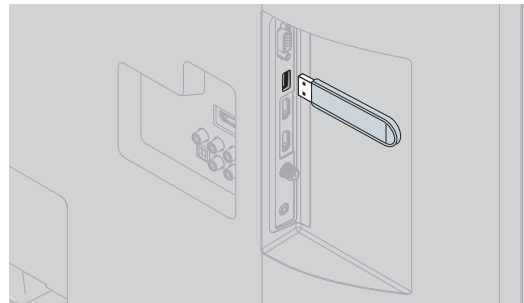

- 2 Press **MENU** and use **▲▼** to select **Features**, then press **OK**.
- 3 Use **▲▼** to select **Software upgrade**, then press **OK**.
- 4 Use **▲▼** to select **Upgrade**, then press **OK**.
- 5 Read the On-screen instructions and confirm that you want to continue with the installation.

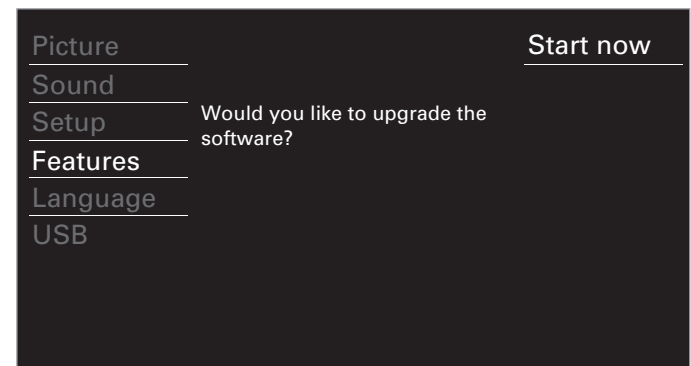

- 6 When the software upgrade is completed, press **⏻** to set the unit into standby mode, then remove the USB memory stick and then press **⏻** again to turn the unit back on.

- The TV starts up with the new software.
For further assistance, please contact the call center.

6 Useful tips

FAQ

Question	Answer
My remote control does not work. What should I do?	<ul style="list-style-type: none"> • Check the antenna or cable connection to the main unit. • Check the batteries on the remote control. • Re-insert or replace the AAA batteries with their polarities (+/-) as indicated on the remote control battery area. • Check if there is an obstacle between the infrared sensor window and the remote control. • Test the IR signal output use IR signal check. ➡ p. 36 If okay, then possible infrared sensor trouble. • Aim the remote control directly at the infrared sensor window on the front of the unit. • Reduce the distance to the unit. • When there is an infrared-equipped device such as PC near this unit, it may interrupt the remote control signal on this unit. Move the infrared-equipped device away from this unit, change the angle of the device's infrared sensor or turn off the infrared communication function.
How come the initial setup appears every time I turn on this unit?	<ul style="list-style-type: none"> • Connect the RF coaxial cable directly to this unit and run the initial setup. • Make sure to complete the initial setup before the unit goes into standby mode.
Why can I not watch some RF signal TV programs?	<ul style="list-style-type: none"> • Autoprogram must be completed when you set up the unit for the first time or move it to a location where previously unavailable channels are broadcast. • Make sure Autoprogram has been completed. ➡ p. 23 • The selected channel may not be broadcasting. • When Autoprogram is interrupted and not completed, some channels will not be received. Make sure to complete the Autoprogram. ➡ p. 23 • The selected channel cannot be viewed by the Child and Ratings Lock setting. ➡ p. 26 • The unit requires some kind of antenna input. An indoor antenna (Digital or VHF / UHF), an external antenna (Digital or VHF / UHF) or an RF coaxial cable from your wall cable or set-top box needs to be plugged into the unit.
How come there is no image from the connected external devices?	<ul style="list-style-type: none"> • Check if the correct input mode is selected by pressing SOURCE or using CH + / -. Refer to Watching Channels from an External Device. ➡ p. 17 • Check the antenna, cable or other input connection to the unit. • When using the component video connection check that the green (Y), blue (Pb/Cb) and red (Pr/Cr) connectors are connected to their corresponding colored jacks on the unit.
When I enter a channel number, why does it change automatically?	<ul style="list-style-type: none"> • Many digital channels have alternate channel numbers. The unit changes the numbers automatically to the ones signifying the broadcasting station's channel number. These basic numbers used for the previous analog broadcasts. (e.g., input digital ch# 30 automatically changes to digital ch# 8.1)
Why are captions not displayed entirely? Or why are captions delayed behind the dialog?	<ul style="list-style-type: none"> • Closed captions that are delayed a few seconds behind the actual dialog are common for live broadcasts. Most captioning production companies can display a dialog to maximum of 220 words per minute. If a dialog exceeds that rate, selective editing is used to insure that the closed captions remain up-to date with the current TV screen dialog.
How can I set the clock?	<ul style="list-style-type: none"> • There is no clock function on this unit.
My PIN code no longer works, how can I change the child lock setting?	<ul style="list-style-type: none"> • If a Power failure occurs for longer than 10 seconds the child lock setting is retained, but the PIN code is reset to the default code 0000. Refer to Child and Ratings Lock. ➡ p. 26

Troubleshooting tips

If the unit does not perform properly when operated as instructed in this Owner's manual,

Please check the following Troubleshooting tips and all connections once before calling for service.

Power

No power

- Make sure the AC power cord is plugged in.
- Make sure that the AC outlet supplies the proper voltage, plug another electrical appliance into the AC outlet to ensure that the AC outlet operates normally.
- If a power failure occurs, unplug the AC power cord for 1 minute to allow the unit to reset itself.

Remote

Control keys do not work.

- Do NOT press more than one key at the same time.
- Ensure that no keys on the remote control are depressed and move freely.

Universal remote control does not work properly.

- Refer to the Owner's manual of the universal remote control for the SANYO code.

Picture

Power is on but no screen image.

- Check whether the connection for the antenna, cable or set-top box is connected correctly.
- Check whether all the cables to the unit are connected to the correct output jack on your separate device like Blu-ray disc / DVD recorder.
- Make sure that the selected input mode is connected to the working input jack.
- Check if your computer is NOT in sleep mode when the input mode on this unit is in PC mode. Tap any key on the computer keyboard to wake it up.

No color

- View other TV channels. The problem might be limited to the broadcasting station.
- Adjust Color in Picture settings. ➡ p. 21





Picture poor

- Adjust Contrast and Brightness in Picture settings. ➡ p. 21
- For the best picture quality, watch "High Definition" wide screen programs. If the HD content is not available, watch "Standard Definition" programs instead.

You see pixelation on the screen.

- When the capabilities of the unit exceed the capabilities of the digital broadcasting, the signal will be increased to match the capabilities of the display on the unit. This may cause pixelation, noise or trash.

Unusual picture appears and the TV does not operate.

- Press the power key first. If it does not solve the problem, then press the keys on the remote control in the order shown below to change the unit to the live mode.
SLEEP ➡ PIX SHAPE  ➡  ➡  ➡  ➡ 

Sound

No sound, distorted sound or incorrect audio sound is heard when using the HDMI-DVI connections.

- Make sure that the analog audio signals from the HDMI-DVI device are connected to the analog audio (L/R) input jacks.
Refer to For PC Input signal ➡ p. 19
- When using Component analog video, Composite analog video or HDMI-DVI video make sure that the analog audio (L/R) connectors are mounted into the audio (L/R) input jacks.

Sound intermittent or no sound.

- Check if the audio cable is connected into the unit correctly.

You switch to a different input and the volume changes.

- This unit will memorize the volume level from the last time you adjusted it.
- If the volume of the sound from another device is higher or lower, then the loudness will change.
- Make sure Auto volume leveling is set to On. ➡ p. 22



Although audio is output through an external amplifier, Voice guide is not output.

- By configuring Digital output format (➡ p. 22) to PCM, Audio with Voice guide will be output through the external amplifier.

Picture & Sound

No picture or sound

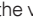
- Check if the power is on.
- Check whether all the cables to the unit are connected to the correct output jack of your device like Blu-ray / DVD recorder.
- View other TV channels. The problem might be limited to the broadcasting station or weak signal strength, if DTV channel check signal strength. Refer to Antenna confirmation ➡ p. 24.
- Unplug the AC power cord and wait for about 1 minute, then plug the AC power cord and turn on the unit again.
- Check whether the connection of the antenna or cable or set-top box is connected correctly.

- Make sure that the selected input mode is connected to the working input jack.
- Check if your computer is NOT in sleep mode when the input mode of this unit is in PC mode. Tap any key on the keyboard to wake up your computer.
- Make sure that the sound is not muted. Press  so that the volume bar and current volume level will appear on the TV screen.
- Make sure that the volume is NOT set to 0 or . If so, use VOL + / - to adjust to the desired volume.

Adjusted picture or sound settings are not the same (memorized) every time the unit is turned on.

- You must set Home in Location. ➡ p. 30 (Otherwise, the settings you adjusted will not be memorized after the unit goes into standby mode.)

You see a distorted picture or hear an unusual sound. (Analog TV - NTSC signal)

- You may be getting interference from electrical appliances, automobiles, motorcycles or fluorescent lights.
- Try moving the unit to another location to see if this is the cause of the problem.

Ghosts, lines or streaks in picture. (Analog TV- NTSC signal)

- Electrical interference from nearby appliances may affect picture quality.
- View other TV channels. The problem might be limited to the broadcasting station or weak signal strength, if DTV channel check signal strength. Refer to Antenna confirmation ➡ p. 24.

Picture poor, sound intermittent or no sound

- View other TV channels. The problem might be limited to the broadcasting station or weak signal strength, if DTV channel check signal strength. Refer to Antenna confirmation ➡ p. 24.

Screen

You switch to a different input and the screen size changes.

- This unit will memorize the viewing mode from the last time you used those particular input modes.

The display image does not cover the entire screen.

- If you are watching TV or using the Composite video, Component video or HDMI with 480i input, press PIX SHAPE  repeatedly to switch to various screen modes.

Different color marks on the TV screen

- View other TV channels. The problem might be limited to the broadcasting station, missing data or pixelation due to weak signal strength.

Closed captions

Closed captions are displayed as a white box. No closed captions are displayed in the closed captions-supported program.

- Interference from buildings or weather conditions may cause captioning to be incomplete if watching Analog TV signals.
- Broadcasting station may shorten the program to insert advertisements.
- The closed captions decoder cannot read the information of a shortened program.

Black box is displayed on the TV screen.

- The text mode is selected. For closed captions, select CC-1, CC-2, CC-3 or CC-4. ➡ p. 25
- If connected to a Blu-ray / DVD device then closed captions are part of its video signal and is only controlled through this device's menu or remote control. Remove the TV closed captions mode.

Note(s)

- The LCD screen is manufactured to provide many years of useful life. Occasionally a few non active pixels may appear as a fixed point of blue, green or red.
This is not to be considered a defect in the LCD screen.
- Some functions are not available in specific modes, but this is not a malfunction. Read the description in this Owner's manual for more details on correct operations of this unit.

7 Information

Glossary

Analog TV (NTSC)

Acronym that stands for National Television Systems Committee and the name of analog broadcasting standards.

Off the air analog TV signals are no longer being sent by major broadcasting stations in the USA.

Aspect ratio

The width of a TV screen relative to its height. Conventional TVs are 4:3 (in other words, the TV screen is almost square); widescreen models are 16:9 (the TV screen is almost twice as wide as its height).

CEC (Consumer Electronics Control)

This allows you to operate the linked functions between our brand devices with CEC feature and this unit. We do not guarantee 100% interoperability with other brands of CEC compliant devices.

Component video

This is a Video signal format that conveys each of 3 principal colors of light (red, blue and green) through different signal lines. This allows the viewers to experience picture colors as original as it is. There are several signal formats, including Y / Pb / Pr and Y / Cb / Cr.

Dolby Digital

The system developed by Dolby Laboratories to compress digital sound. It offers stereo sound (2ch) or multi-channel audio.

DTV (ATSC)

Abbreviation that stands for Advanced Television Systems Committee and the name of the digital broadcasting standards.

E-sticker

E-sticker is showing set features, technical information, etc on this TV set that is displayed on the TV screen mainly used by TV retailers. Previously the information was on a printed sticker that was put on the display.

HDMI (High-Definition Multimedia Interface)

Interface that supports all uncompressed, digital audio / video formats including set-top box, Blu-ray / DVD recorder or digital television, over a single cable.

HDTV (High-Definition TV)

Ultimate digital format that produces high resolution and high picture quality.

PIN code

A stored 4-digit number that allows access to parental control features.

SAP (Secondary Audio Program)

Second-audio channel delivered separately from the Main-audio channel. This audio channel is used as an alternate in bilingual broadcasting.

SDTV (Standard Definition TV)

Standard digital format that is similar to the analog TV picture quality.

Maintenance

Cleaning

- Clean the front panel and other exterior surfaces of the unit with a soft microfiber cloth or lens brush. Before cleaning the panel, disconnect the AC power cord.
- Never use a solvent or alcohol. Do not spray insecticide liquid near the unit. Such chemicals may cause damage and discoloration to the exposed surfaces.
- Do not spray any liquids on the screen or other exterior surfaces of this unit. If liquids enter the unit, they could cause shorts, electric shocks or fire damage.

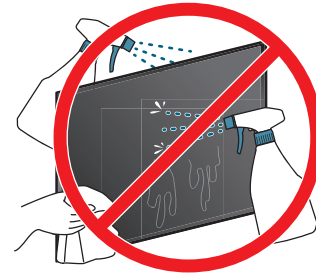

Servicing

Should your unit become inoperative, do not try to correct the problem yourself. There are no user serviceable parts inside. Call our toll free customer support line found on the cover of this Owner's manual to locate an authorized service center.

IR signal check

If the remote control is not working properly, you can use a digital or cell phone camera to see if it is sending out an infrared signal.



e.g.) With a digital camera:

Point the digital camera towards the remote control infrared diode at the front of the remote control. Press and hold any key on the remote control and look at the camera display. If an infrared pulsating light appears on the display, the remote control is sending out an IR signal.

Note: Some cameras may have an IR filter or dual camera cell phones may have an IR filter in one of the camera's and both will not display the IR signal.

8 Specifications

Model #	FW55D25F
Picture	
Type	FHD (Full HD) (1920 x 1080 pixels 60Hz)
Aspect Ratio	16:9
Viewing Angles	178° (V) by 178° (H)
Built-in Digital / Analog Tuner	ATSC (Digital) / NTSC (Analog)
Sound	
Mono / Stereo	Mono, Stereo, Virtual Surround Sound
Power Output (RMS watts)	10W x 2
Equalizer	5 Band
Ease of Use	
Pix Shape	SD (4:3 Source) : Normal / 16:9 / Movie expand / Zoom / Wide HD (16:9 Source) : Normal / 4:3 / Movie expand / Zoom / Wide HDMI AV (4:3 Source) : Normal / 16:9 / Movie expand / Zoom / Wide / Full HDMI AV (16:9 Source) : Normal / 4:3 / Movie expand / Zoom / Wide / Full PC Source : Normal / Full / Unscaled (Refer to HDMI AV (16:9 Source) above if PC has HDMI Output.)
Photo Slide Show	JPEG Files Only
Video Playback	Only Motion JPEG 320 x 240, 30 fps with file extension "avi" will Playback
Channel	
Channel Coverage	Terrestrial DTV : VHF: 2~13 (ATSC) UHF: 14~69 (Each Channel has e.g. 2.1~2.9, 3.1~3.9, etc)
	Terrestrial Analog : VHF: 2~13 (NTSC) UHF: 14~69
CATV (Analog NTSC)	2~13, A~W W+1~W+94 (Analog W+1~W+84), A-5~A-1, 5A
Tuning System	Channel Frequency Synthesized Tuning System
Channel Access	Direct Access Number Keyboard, Programmable Scan, Channel +(up) / -(down) and PREV. CH (Previous Channel)
Connectivity	
Component Video Input (Y/Pb/Pr)	1 Supporting Video Signals : 480i/p, 720p, 1080i @60Hz
Composite Video Input (Shared Y Green Terminal with Component Video)	1
HDMI Input	3 Supporting Video Signals : 480i/p, 720p, 1080i @60Hz, 1080p @24/30/60Hz PC-Input Signal up to FHD (Full HD) (1920 x 1080)
Analog Audio L/R Input	1
PC Input	Via VGA, HDMI and HDMI-DVI + Analog Audio L/R
USB	1
Digital Audio Output	1 Supporting Dolby Digital
Headphone Output	1 1/8 inch (3.5mm)
Power	
Power Requirements	120V~ +/- 10%, 60Hz +/- 0.5%
Temperature	
Operating Temperature	41 °F (5 °C) to 104 °F (40 °C)

- Specifications are subject to change without prior notice.

9 Warranty

Limited warranty one (1) year parts and labor

Warranty coverage:

This warranty obligation is limited to the terms as set forth below.

Who is covered:

This product warranty is issued to the original purchaser or the person receiving the product as a gift against defects in materials and workmanship as based on the date of original purchase ("Warranty Period") from an Authorized Dealer. The original sales receipt showing the product name and the purchase date from an authorized retailer is considered such proof.

What is covered:

This warranty covers new products if a defect in material or workmanship occurs and a valid claim is received within the warranty period. At its option, the company will either (1) repair the product at no charge, using new or refurbished replacement parts, or (2) exchange the product with a new or refurbished product at company's option.

Replacement products or parts provided under this warranty are covered against defects in materials and workmanship from the date of the replacement or repair for ninety (90) days or for the remaining portion of the original product's warranty, whichever provides longer coverage for you. When a product or part is exchanged, any replacement item becomes your property and the replaced item becomes company property. When a refund is given, your product becomes company property.

Note: Any product sold and identified as refurbished or renewed carries a ninety (90) day limited warranty.

Replacement product can only be sent if all warranty requirements are met. Failure to follow all requirements can result in delay.

What is not covered - Exclusions and limitations:

This limited warranty applies only to new company manufactured products that can be identified by the trademark, trade name, or logo affixed to it. This limited warranty does not apply to any hardware product or any software, even if packaged or sold with the product, as manufacturers, suppliers, or publishers may provide a separate warranty for their own products packaged with the bundled product.

The company is not liable for any damage to or loss of any programs, data, or other information stored on any media contained within the product, or other additional product or part not covered by this warranty. Recovery or reinstallation of programs, data or other information is not covered under this limited warranty.

This warranty does not apply (a) to damage caused by accident, abuse, misuse, neglect, misapplication, or non-supplied product, (b) to damage caused by service performed by anyone other than company approved Authorized Service Location, (c) to a product or a part that has been modified without written company permission, or (d) if any serial number has been removed or defaced, or (e) product, accessories or consumables sold "AS IS" without warranty of any kind by including refurbished product sold "AS IS" by some retailers.

This limited warranty does not cover:

- Shipping costs for returning defective product.
- Labor charges for installation or setup of the product, adjustment of customer controls on the product, and installation or repair of antenna/signal source systems outside of the product.
- Product repair and/or part replacement because of improper installation or maintenance, connections to improper voltage supply, power line surge, lightning damage, retained images or screen markings resulting from viewing fixed stationary content for extended periods, product cosmetic appearance items due to normal wear and tear, unauthorized repair or other cause not within the control of the company.
- Damage or claims for products not being available for use, or for lost data or lost software.
- Damage from mishandled shipments or transit accidents when returning product.
- A product that requires modification or adaptation to enable it to operate in any country other than the country for which it was designed, manufactured, approved and/or authorized, or repair of products damaged by these modifications.
- A product used for commercial or institutional purposes (including but not limited to rental purposes).
- Product lost in shipment and no signature verification receipt can be provided.
- Failure to operate per Owner's Manual.

To obtain assistance...

Contact the Customer Care Center at:

www.sanyo-av.com

1 866 212 0436

REPAIR OR REPLACEMENT AS PROVIDED UNDER THIS WARRANTY IS THE EXCLUSIVE REMEDY FOR THE CONSUMER, WITH THE ISSUING COMPANY NOT LIABLE FOR ANY INCIDENTAL OR CONSEQUENTIAL DAMAGES FOR BREACH OF ANY EXPRESS OR IMPLIED WARRANTY ON THIS PRODUCT. EXCEPT TO THE EXTENT PROHIBITED BY APPLICABLE LAW, ANY IMPLIED WARRANTY OF MERCHANTABILITY OR FITNESS FOR A PARTICULAR PURPOSE ON THIS PRODUCT IS LIMITED IN DURATION TO THE DURATION OF THIS WARRANTY.

Some states do not allow the exclusions or limitation of incidental or consequential damages, or allow limitations on how long an implied warranty lasts, so the above limitations or exclusions may not apply to you.

This warranty gives you specific legal rights. You may have other rights which vary from state/province to state/province.

Funai Service Corporation, 2425 Spiegel Drive, Groveport, OH 43125, USA

SANYO

AYGRKUH
★★★